



LOS ANGELES MEMORIAL
COLISEUM
TECHNICAL GUIDE

TABLE OF CONTENTS

THE LOS ANGELES MEMORIAL COLISEUM	1
CONTACTS & PHONE NUMBERS	2
SITE PLAN	3
Vehicle Access.....	4
Security and Hours.....	4
Shipping Packages	4
LOAD-IN	4
COLISEUM LOCATIONS	5
Capacity	6
Height Measurements	6
ROOMS AND AREAS	7
Locker Rooms	7
Rooms and Offices	9
Scholarship Club Tower	9
Field Dimensions	19
INVENTORY	20
Concessions	22
FOOD & BEVERAGE	22
Catering	23
Catering Terms and Conditions.....	25
Craft Services	27
Responsible Alcohol Service.....	27
Elevators	29
FACILITIES	29
Entrance Gates.....	30
Media/VIP Entry.....	32
Network	32
Peristyle	34
Power.....	36
Restrooms	38
Seating	39
Ticketing.....	39
Utilities.....	40
Waste Hauling.....	42
Water	43
ACCESSIBLE SERVICES	44
FIELD GUIDELINES	47
PARKING	49
Event Parking	50
Truck Staging/Bus Parking.....	51
Digital Parking.....	51
Directions	51
Metro	51
Basic Safety	53
Los Angeles Department of Building Safety (LADBS).....	53
Cable Installation	53
BUILDING SAFETY REQUIREMENTS	53
Electrical/Wiring	54
Fan Conduct Policy	54
Prohibited Items	55
Clear Bag Policy.....	56
Floor Plans.....	57
On-Site Fire Inspector.....	57
Permits.....	57
Permanent Building Signs	59
Temporary Event Signs	59
Flag Poles	59
Banc of California Stadium.....	59
EXPOSITION PARK	60
NOISE Curfew	60
STAFFING	60
Call Times	60
AREA SERVICES	61
Dry Cleaning/Laundry	61
Hotels	61
Hospitals	61
Fire Station	62
Police Station	62
Pharmacy.....	62
Rideshare	62
Taxi/Limo.....	62

THE LOS ANGELES MEMORIAL COLISEUM



Known as “The Greatest Stadium in the World”, the Los Angeles Memorial Coliseum is a National Historical Landmark and living memorial to all who served in the U.S. Armed Forces during WWI. The Coliseum has been considered a civic treasure for generations of Angelenos, and is the only venue worldwide to host two Summer Olympics (X Olympiad in 1932, XXII Olympiad in 1984) and will soon host a third (XXXIV Olympiad in 2028.) The building also proudly hosted Super Bowls I and VII, the 1959 World Series, and has been home to USC Trojan Football since 1923. From Mick Jagger to the Harlem Globetrotters, the Grateful Dead to Billy Graham, Evel Knievel to Pele, and John F. Kennedy to Van Halen, the Coliseum is the stage for the unbelievable, the unforgettable, the iconic, and the best in human endeavor and achievement.

This technical guide, a supplement to the LA Coliseum Promoter Guide, provides detail and specifications on many aspects of the venue. Please do not hesitate to contact us with any questions or assistance needs.

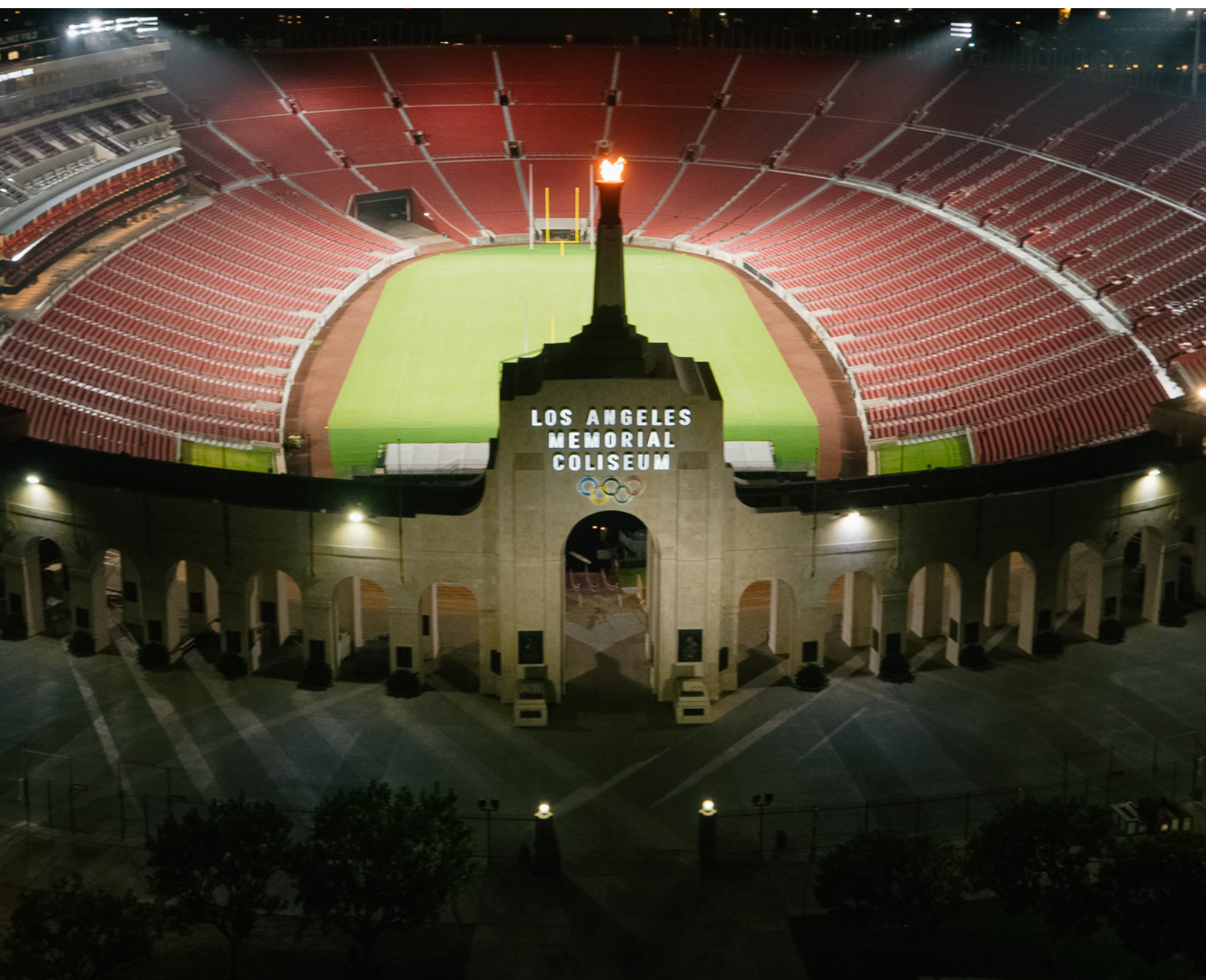

CONTACTS & PHONE NUMBERS



Joe Furin
General Manager
213.765.6342 | furin@usc.edu



Teresa Guy
Director of Booking and Partnerships
213.765.6319 | tguy@usc.edu



Sacha Tani
Senior Sales Manager for Private Events
213.765.6313 | sachatani@usc.edu



Kevin Daly
Assistant General Manager
213.736.6348 | kevind@usc.edu



Sherry Caldwell
Director of Box Office
213.765.6343 | sherry.caldwell@usc.edu



Matthew Buswell
Assistant Director,
Facility and Event Operations
213.765.6342 | buswell@usc.edu



Gabe Ochoa
Assistant Director,
Coliseum Technical Operation
213.765.6358 | gochoa@usc.edu



Janet Gutierrez
Senior Event Manager
213.765.6309 | janet.gutierrez@usc.edu



Frances Guererro
Event Manager
213.765.6308 | fguererr@usc.edu



Tina Bonnmag
Event Manager
213.765.6307 | boonmag@usc.edu



Clark Shafer
Senior Manager of Facility Operations
213.765.6322 | cshafer@usc.edu



William Dix
Lead Electrician
213.765.6342 | wdix@usc.edu

SITE PLAN

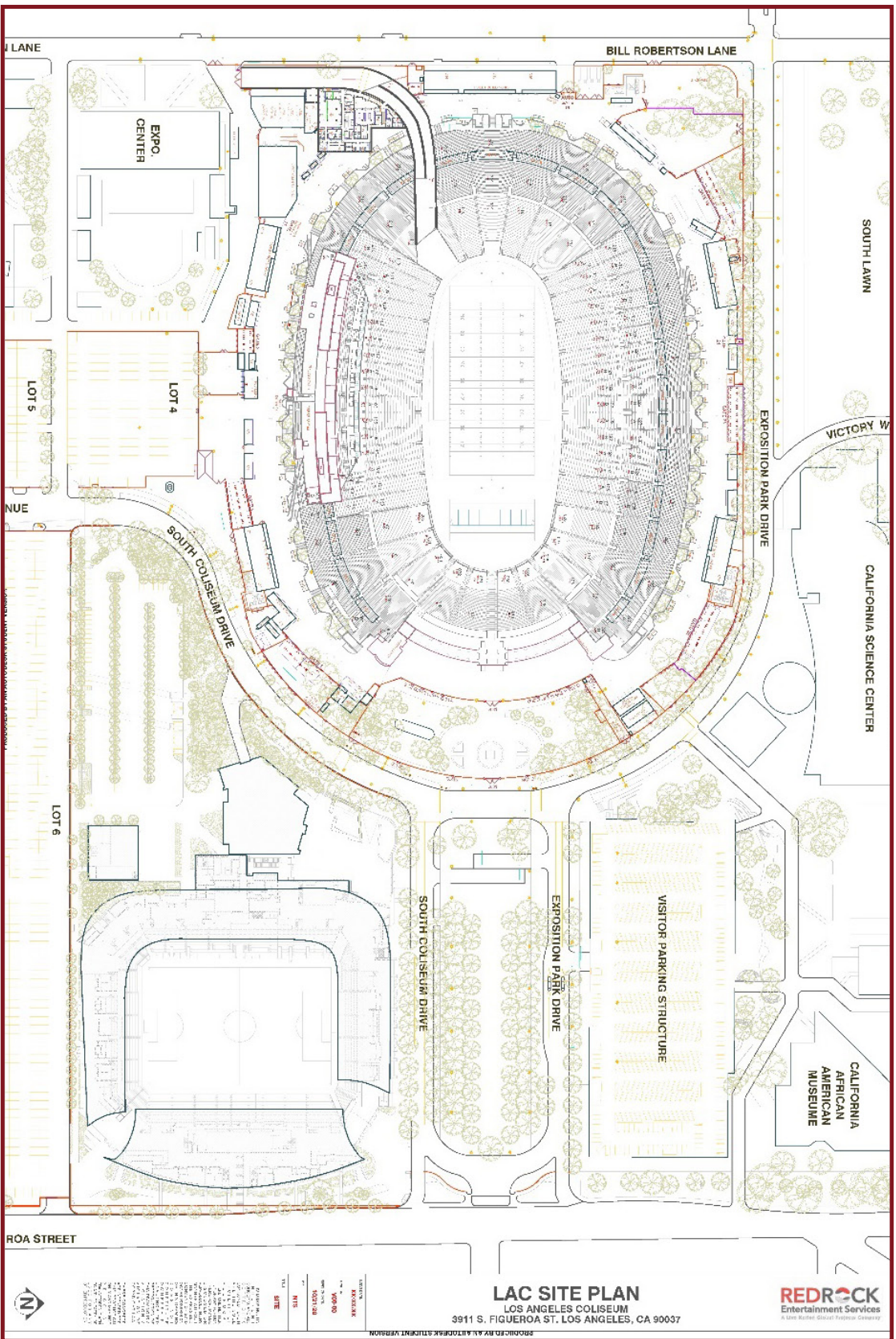

Download this site plan by [clicking here](#) (link to Google Drive folder)



VEHICLE ACCESS

Vehicle access to the Coliseum is located on the west side of the venue via Bill Robertson Lane.

For access to the concourse area, use Gate 16 (3900 Bill Robertson Lane, 90037)

For access to the field, use the field tunnel (3960 Bill Robertson Lane, 90037)

Additional vehicle access can be coordinated from S. Coliseum Dr. at the Broadcast Compound and Gate 33.

All vehicles and deliveries entering must either have previous approval for access or must always display appropriate identification. Upon load-in completion, all vehicles must be removed from any public access areas, including golf carts. Load-out may only be started once the facility has been determined to be completely clear of any patrons, typically a minimum of one hour after the conclusion of an event.

SECURITY AND HOURS

The Coliseum has a 24-hour security watch at Gate 16 with delivery access from 6:00am – 4:00pm. Load-in days are calculated on a maximum 14-hour shift. For additional hours, please discuss with your event manager. Additional fees may be required.

Medical will be staffed during load-in for any production with a structural build or for more than 8 hours. Medical is always staffed during events.

SHIPPING PACKAGES

All packages should be shipped to:

Los Angeles Memorial Coliseum
Attn: Event Manager/Event Name
3911 South Figueroa St.
Los Angeles, CA 90037

If a package is for a specific event, it **must** be shipped to the attention of the event manager.

COLISEUM LOCATIONS

The Coliseum is comprised of five main areas:

- **Field Level:** contains the playing field, field turf areas and field court.
- **Locker Rooms:** elevated slightly above the field level; accessible only from the field tunnel.
- **Street Level/Concourse:** main level of entry to the Coliseum; access to the Peristyle and Olympic Plaza.
- **Upper Concourse (UC) Level:** second level of the Coliseum seating bowl
- **Scholarship Club Tower (see Rooms):** premium seating area of the Coliseum, featuring multi-use areas, conference rooms, and suites.



Area	Dimensions	Measurements	Capacity
Coliseum	784,080 SF/ 18 acres	-	76,618
Playing Field	135,837 SF	Football: 53.33 yds. x 120 yds. Rugby: 60m x 107m Soccer: 70 yds. x 110 yds.	10,012
Field Court (cement)	12,800 SF	160 ft x 80 ft	1,000

Area	Dimensions	Measurements	Capacity
Peristyle Deck	11,000 SF	-	846
Peristyle Plaza	28,850 SF	15 arches	2,219
Olympic Plaza South	16,100 SF	-	1,238
Olympic Plaza Center	17,600 SF	-	1,353
Olympic Plaza North	18,400 SF	-	1,415

CAPACITY

Capacity of any area may vary depending on production needs and/or current public health and safety conditions and guidelines. An approved floor plan and seating plan must be submitted to Coliseum staff before any event tickets are placed on sale.

Seating Capacity - 76,618

Field Capacity - 10,012

Endzone Suites - 416 (Temporary Structure)

VIP Field Seats - 100 (Soccer Configuration)

HEIGHT MEASUREMENTS

Field Level to Street Level - 40' 9"

Field Level to Height of Coliseum (last row) - 115' 8"

Street Level to Height of Coliseum (last row) - 74' 11"

Street Level to Height of Scholarship Club Tower - 109' 4"

Street Level to Height of Olympic Cauldron - 123' 6"

LOCKER ROOMS

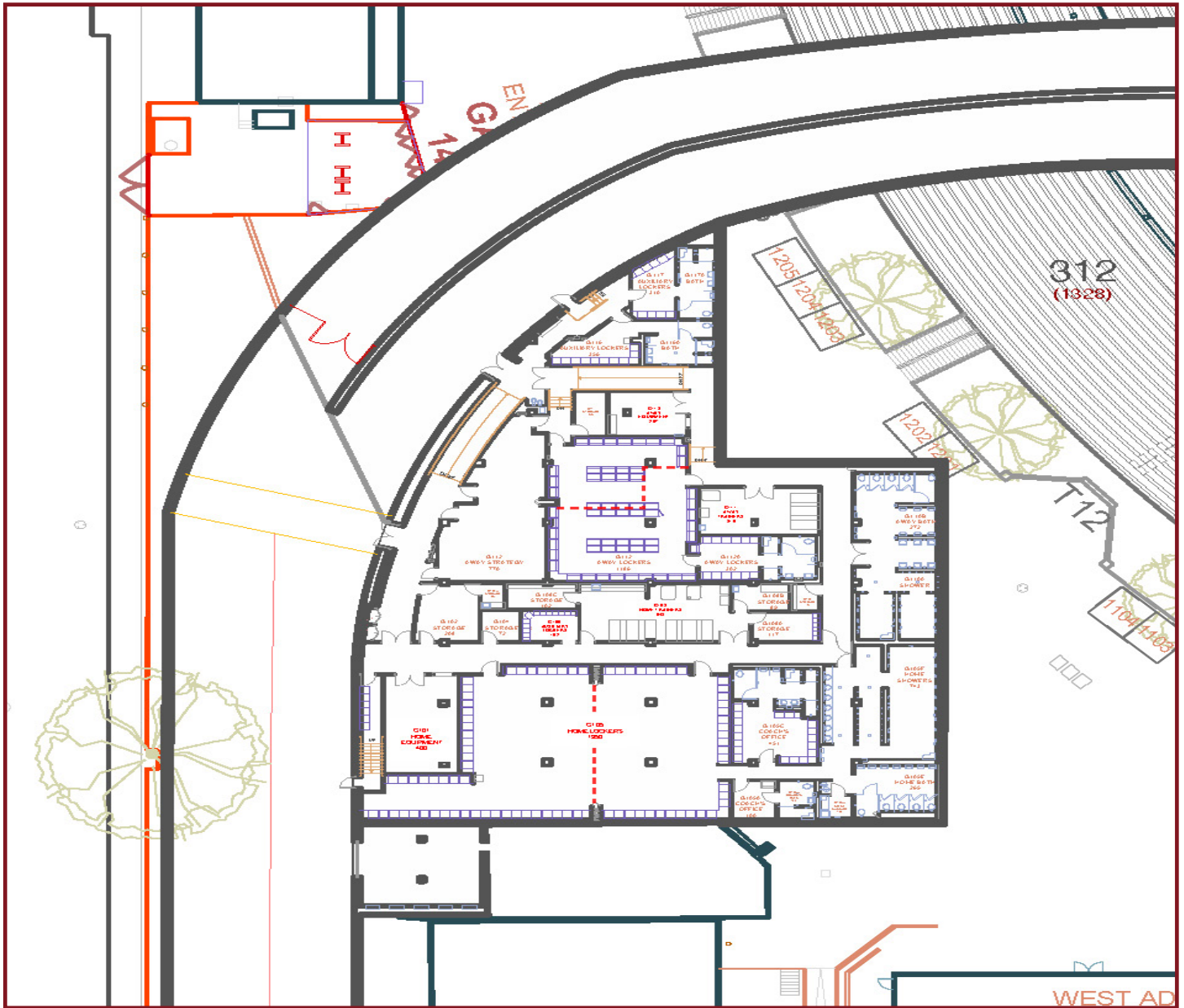

Ref	Room Name	SF	Lockers
G105	Home Locker Room	1950	82
<i>Home Locker Can Be Split</i>			
G105A	-	1392	49
G105B	-	1146	33
G112	Away Locker Room	1149	58
<i>Away Locker Can Be Split</i>			
G112A	-	546	24
G112B	-	603	34
G101	Home Equipment	414	0
G106	Auxiliary Lockers	99	12
G108	Home Trainers	532	0
G111	Away Trainers	321	0
G113	Away Equipment	201	0
G114	Away Strategy/Media Room	746	0
G116	Auxiliary Lockers	185	10
G117	Auxiliary Lockers	152	8



ROOMS AND OFFICES

A virtual tour of our event spaces, rooms, and offices is [available here](#).

Room	Dimensions	Capacity	
Coliseum Boardroom	748 SF	34 ft. x 22 ft.	60
North Office - 1A	680 SF	34 ft. x 20 ft.	60
North Office - 1B	528 SF	24 ft. x 22 ft.	40
North Office - 2	823 SF	20 ft x 15 ft ; 33 ft x 16 ft	50
Game Management Trailer	1800 SF	30 ft x 60 ft. Incl 4 Offices	108
Meeting Room Level 2	399 SF	-	27
Conference Room Level 5	593 SF	-	40

SCHOLARSHIP CLUB TOWER

Scholarship Club Tower Booking Policy

Members of the Trojan Athletic Fund (TAF) Suite, Loge Box, and Club Seat holders have an exclusive first-right-of-refusal to purchase their Scholarship Club Tower seats for all Coliseum events. TAF members have an exclusive first-right-of-refusal 'opt in' period of 72 hours prior to the beginning of the public on-sale or pre-sales. The Event organizer is responsible for setting the price for all manifested seats in the Scholarship Club Tower. Suites and Loge Boxes cannot be ticketed individually, including the 'President's Suite 201', except for designated 'Party Suites' 501, 502, 521, and 522. The Coliseum retains the right to use suite 212 for all events. The Press Box level may not be publicly ticketed. The 1923 Club rooftop deck is available for standing room only public ticketing up to 499 in capacity.

Heritage Concourse

This front alfresco area offers 19,000 square feet of versatile event space topped with an incredible view, multiple full-service bars and kitchens, and a dozen branding opportunities on our IPTV monitors.

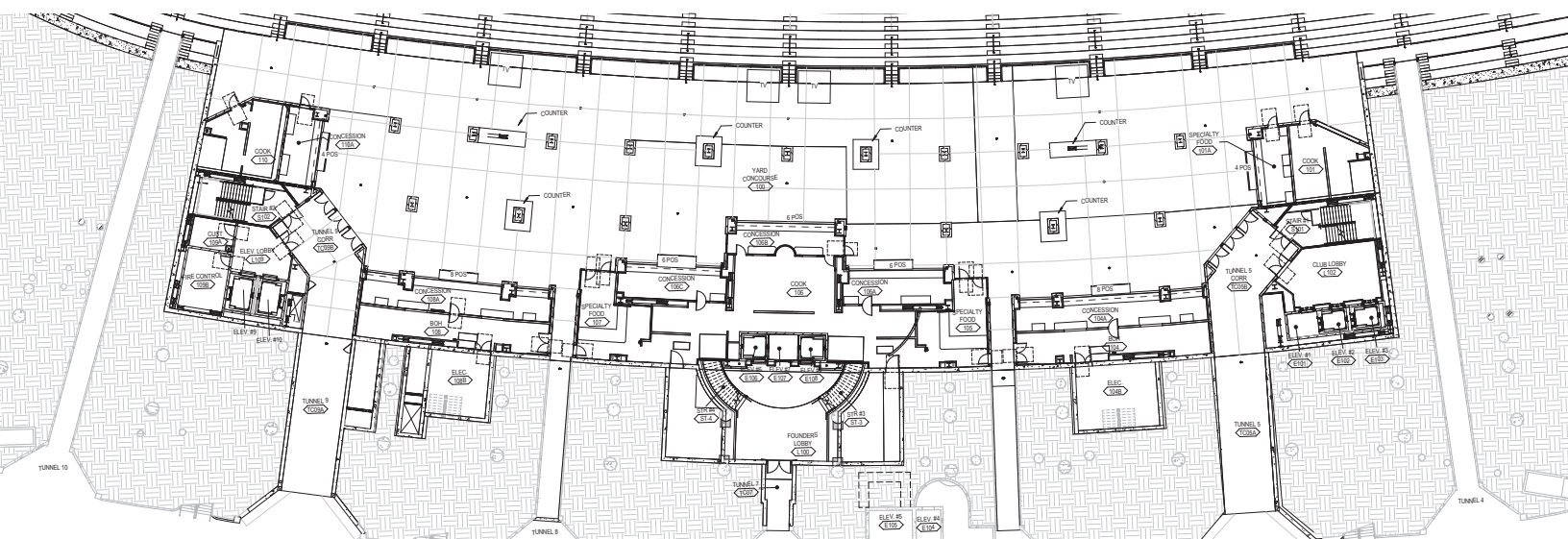

Founders Suites

Inventory	Fixed Outdoor Seats	Indoor Barstool Seats	Coliseum Total
201	83	28	111
205	20	6	26
206	20	6	26
207	20	6	26
208	20	6	26
209	20	6	26
210	20	6	26
211	20	6	26
212	21	6	27
301	23	6	29
302	20	6	26
303	20	6	26
304	20	6	26
305	20	6	26
306	20	6	26
307	20	6	26
308	20	6	26
309	20	6	26
310	20	6	26
311	20	6	26
312	21	6	27
-	-	-	636

Manifest	Level 2 = 320 Level 3 = 316				
Restrooms		Men's Urinal	Men's Stall	Women's Stall	Family Toilet
	Lvl 2	5	3	10	1
	Lvl 3	5	3	10	1
Emergency exit	Stair 1 & 2 to Heritage Concourse				
Other	The Jim and Diane Bashor Founders Club is the lounge and open-floor space on Levels 2 and 3. No lockable space; no personal items may be left in suites.				

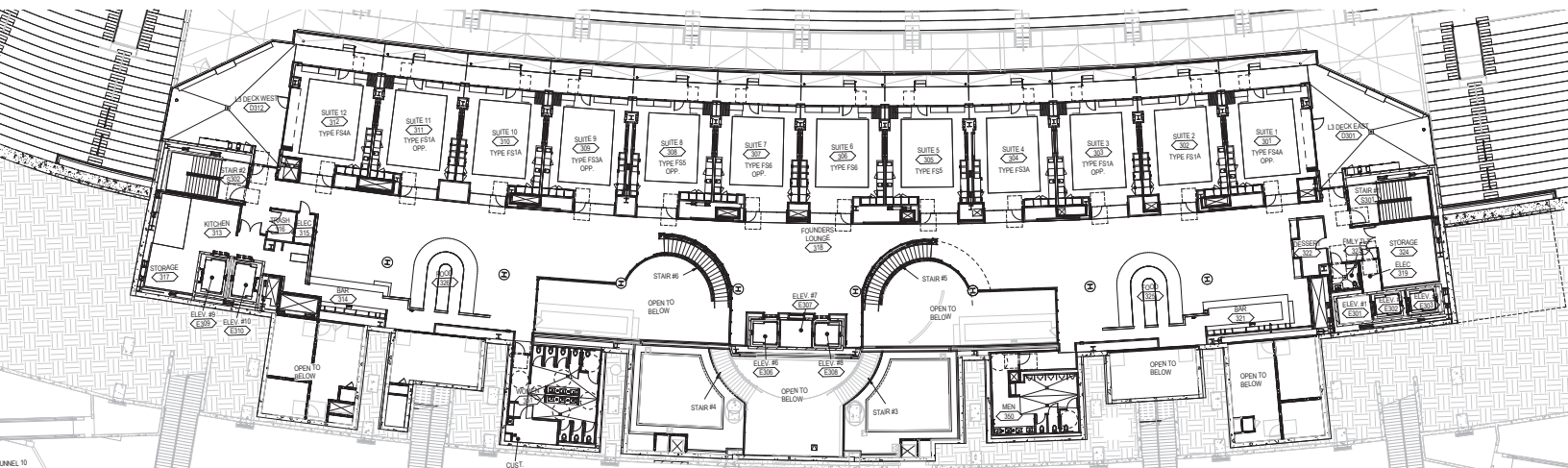
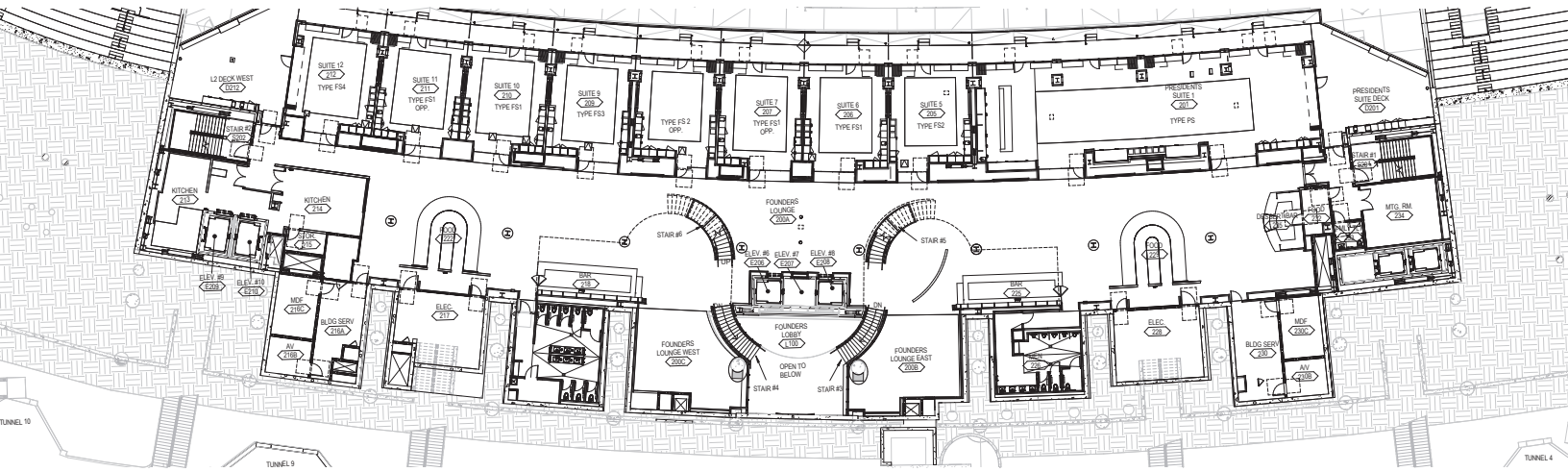

Club Seats and Loge Boxes

Loge Box Inventory	Fixed Outdoor Seats
401	5
402	4
403	4
404	4
405	4
406	4
407	4
408	4
409	4
410	4
411	4
412	4
413	4
414	4
415	4
416	4
417	4
418	4
419	4
420	4
421	4
422	4
423	4
424	6
-	99



Manifest	Club Seats: 1,108 seats Loge Box: 99 Seats			
Restrooms	Men's Urinal 12	Men's Stall 6	Women's Stall 18	Family Toilet 2
Emergency exit	Exit Tower Stair 7, 9, 10, 11, 12, or 8 to Upper Concourse Level			
Other	Loge Boxes designated as LGE401 Loge Boxes 410/411 and 422/423 are joined (no partition) 16 ADA Seats Stair 9 and 12 from the Club Lobby are for exit only.			

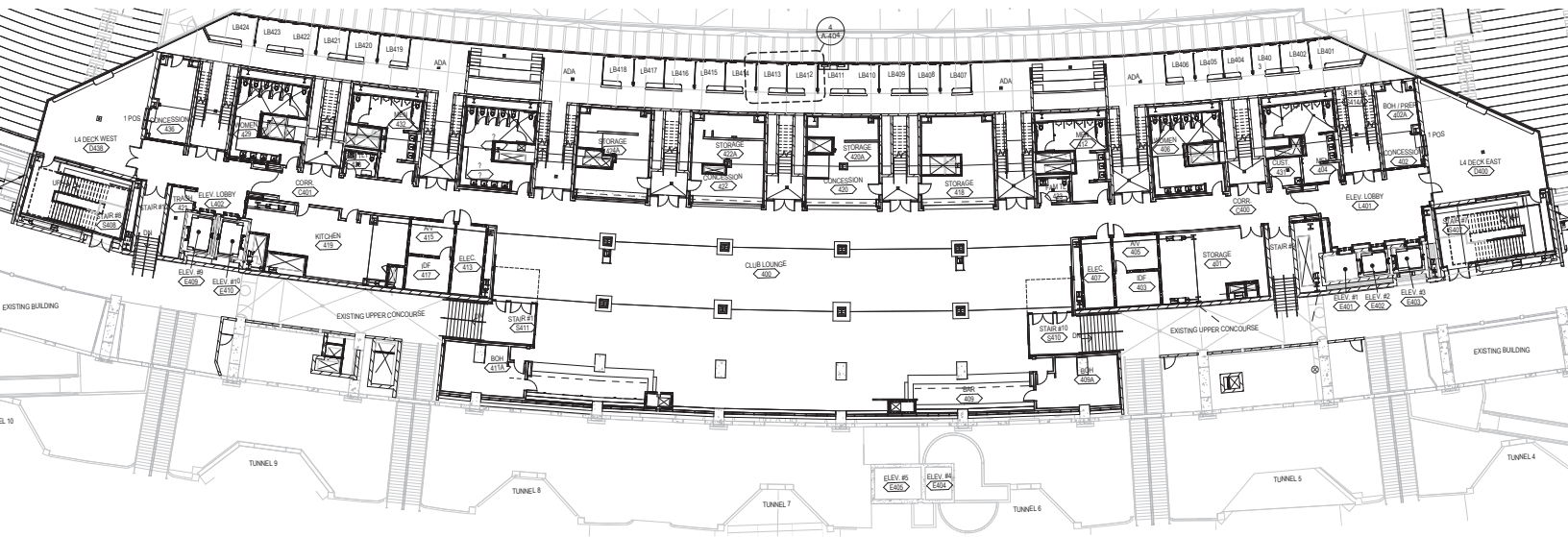

Suite Level

Inventory	Fixed Outdoor Seats	Indoor Barstool Seats	Coliseum Total
501	36	18	54
502	26	10	36
503	13	4	17
504	13	4	17
505	13	4	17
506	13	4	17
507	13	4	17
508	13	4	17
509	13	4	17
510	13	4	17
511	13	4	17
512	13	4	17
513	13	4	17
514	13	4	17
515	13	4	17
516	13	4	17
517	13	4	17
518	13	4	17
519	13	4	17
520	13	4	17
521	26	10	36
522	32	16	48
-	-	-	480



Manifest	Level 5: 480				
Restrooms	Men's Urinal	Men's Stall	Women's Stall	Family Toilet	Staff Toilet
	4	4	8	1	1
Emergency exit	Exit Tower Stair 7, 9, 10, 11, 12, or 8 to Upper Concourse Level				
Other	<p>Suite 522 is not manifested, reserved for LAMC use.</p> <p>Level 5 Lobby Area is known as "Rod's Tiger Lounge", named after long-time USC baseball coach Rod Dedeaux.</p> <p>Level 5 also features a conference room.</p>				

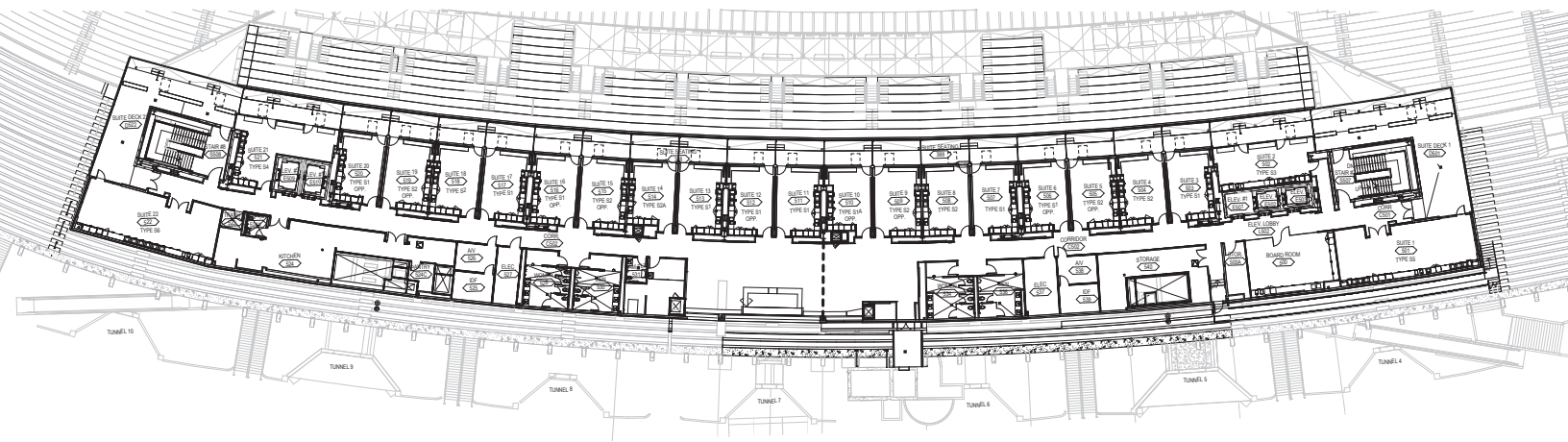

Press Box

Room	USC Designation	Sq. Ft	COVID-19 Cap	Normal Cap	Lower Seats	Upper Seats
602	Security	678	14	28	8	6
-	Dispatch Center	-	-	-	14	-
604	Instant Replay	121	3	4	4	-
606	Medical Replay	122	3	4	4	-
608	Skycam/Aux Radio	142	4	4	4	-
610	National Radio	160	4	6	4	2
612A*	Game Ops/Clock	285	8	2	2	-
612B*	USC Student Radio	-	-	5	5	-
618	Visitor AD	352	10	13	9	4
620	Control Room	617	17	25	-	-
622	Visitor Radio	194	5	6	4	2
-	-	-	-	-	-	-
624A*	Athletics/Aux	481	10	10	10	-
624B*	-	-	-	-	-	-
626	Home Radio	161	4	6	4	2
628	Home Coach	301	8	13	8	5
630	Network TV	376	10	-	-	-
632	Team Video	223	6	4	0	4
634	Visitor Coach	295	8	13	8	5

* These rooms can be joined or split



Restrooms	Men's Urinal 2	Men's Stall 2	Women's Stall 5	Family Toilet 1
Emergency exit	Exit Tower Stair 7, 8 to Upper Concourse Level			
Media to field	Exit Level 6 at Elevator 4 or 5 to Level 1. Proceed through Tunnel 6 to Heritage Concourse to playing field. Alt Route: Exit Level 6 to west exit stairs to Upper Concourse level. Proceed to Upper Tunnel 11 and walk downstairs to field.			
Coaches route to locker room	At least two attendants will be provided to escort coaches between the team locker room and their booths before the game, at halftime, and at the conclusion of the game. Primary Route: Elevators 4 and 5 will be held at the beginning of the game, beginning of halftime, end of halftime and end of game. From Level 6, take Elevator 4 or 5 to Level 1, proceed out through Gate 7 to golf carts for travel to locker room Alt. Route: From Level 6, use service elevators 9 and 10 to Level 1. Proceed out Tunnel 9 to Gate 7 to golf carts for travel to locker room			
Other	Elevator 4 and 5 will be held exclusively for the coaches at the beginning of the game, half time and the end of the game.			

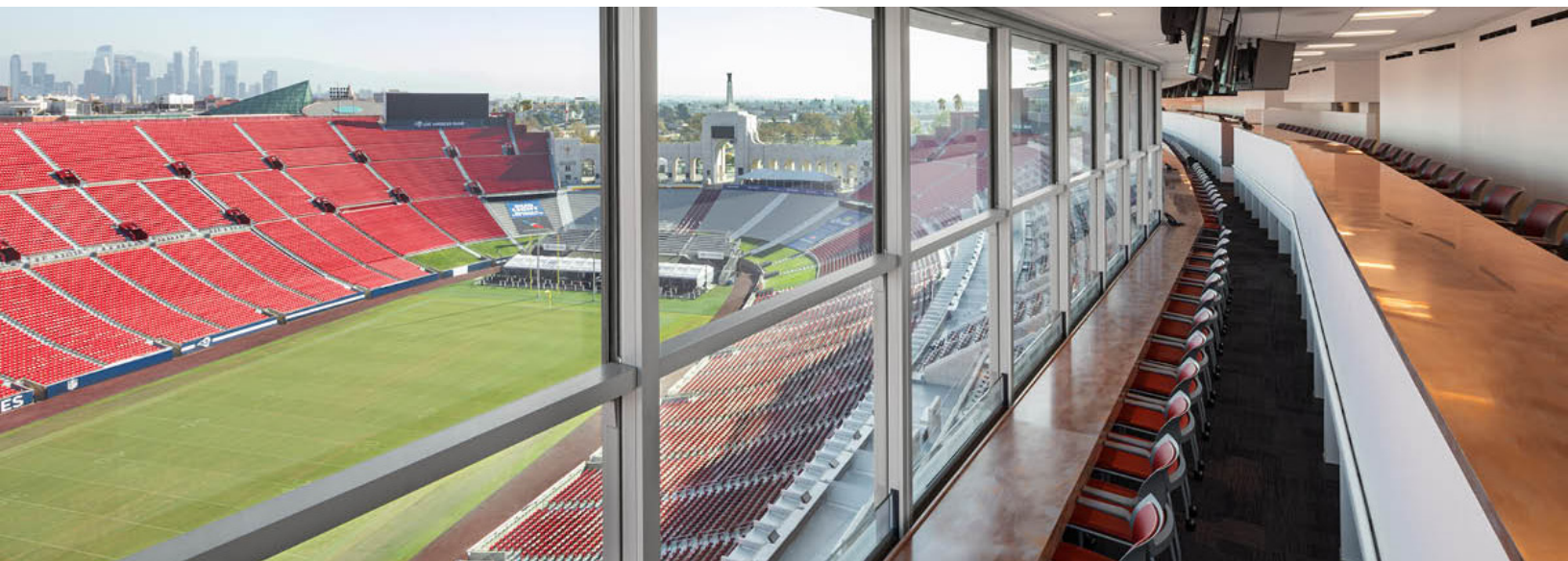
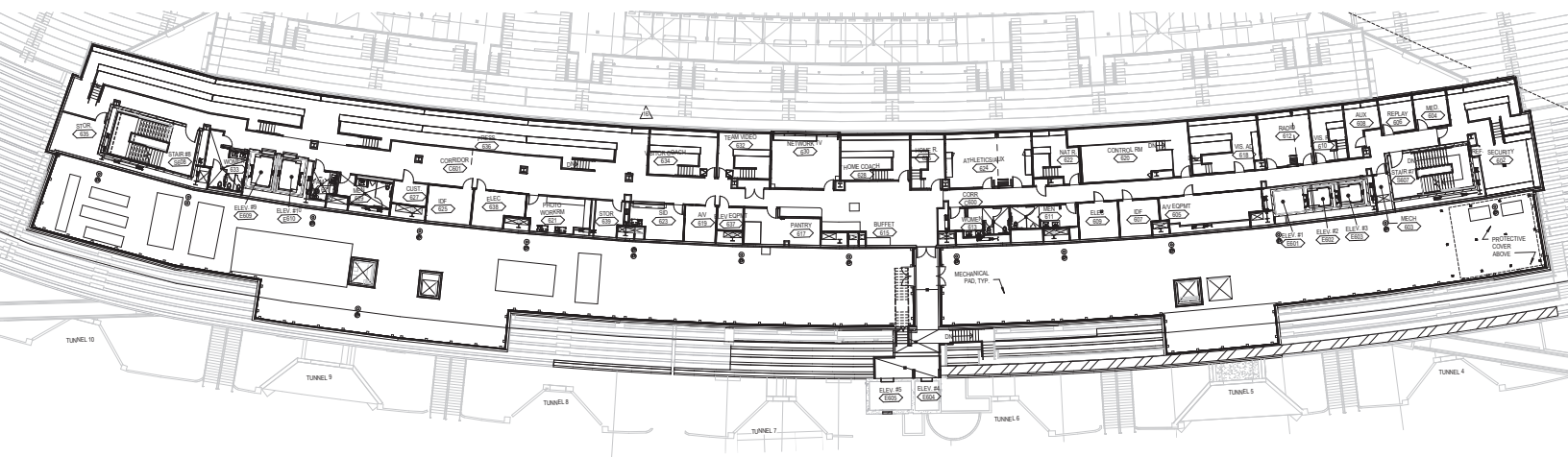

1923 Club

Manifest	499			
Restrooms	Men's Urinal	Men's Stall	Women's Stall	Family Toilet
	4	4	8	1
Emergency exit	Exit Tower Stair 7 or 8 to Upper Concourse Level			
Other	Elevator 3 will also access the Upper Concourse level for ADA assistance only.			

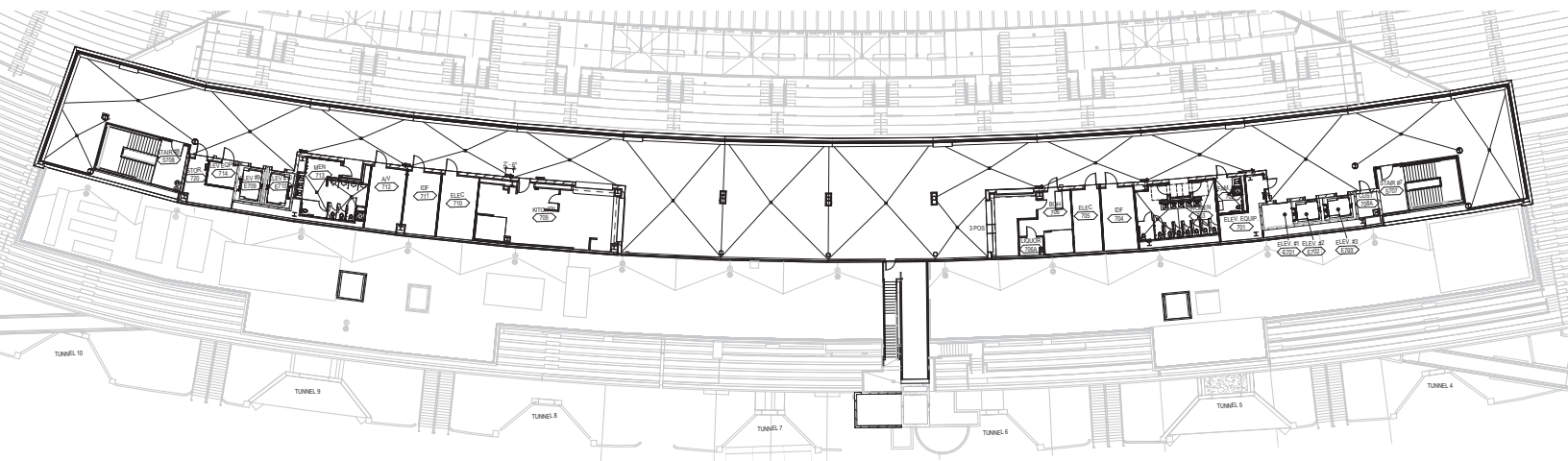

FIELD DIMENSIONS

	Feet	Yards	Meters
East to West:	560 ft.	186.7 yds	170.7 m
North to South:	250 ft. - 222 ft.	-	-
Max Football	360 x 160 ft	120 x 53.3 yds	109.7 x 48.8 m
Max Rugby	350 x 196 ft	116.6 x 65.3 yds	106.7 x 59.7 m
Max Soccer	330 x 210 ft	110 x 70 yds	100.6 x 64 m



INVENTORY

The Coliseum has an inventory of equipment available for use.

Coliseum Stage

- All Terrain H-Frame Stage
- Large dimensions 60ft wide x 40ft long
- Decks come in 4ft x 8ft lengths
- Stage height ranges from 4ft – 6ft
- Stage comes with a pair of adjustable stair units
- Stage comes with side skirting and railing

Z-Frame Stage

- Largest dimensions: 16ft x 20ft
- Decks come in 4ft x 8ft lengths
- Stage height ranges from 1ft – 2ft high
- Stage comes with an adjustable stair unit
- Stage comes with side rails and skirting

Risers

- 8ft x 4ft x 1ft high. Total of 4.
- Mostly used for media events as camera riser
- Covered with black carpet



Tables		Chairs		Linen/Rugs	
6ft Mity Lite	30	Black folding chair	539	Round linen-Black	23
8ft Mity Lite	15	White folding chair	252	Round linen-Red	9
4ft Mity Lite	28	Red padded ADA chair	171	Round linen-Gold	8
6ft Wooden	29	South office chair	60	Round linen-Blue	10
8ft Wooden	59	Commission chair	12	Round linen-White	8
8ft Wooden skinny	12	Home locker room chair	155	6ft table linen	17
8ft Collapsible table	32	Visiting locker room chair	126	8ft table linen	23
Bag Check w/ sticker	123	-	-	Blue table skirting	12
Bag check w/o sticker	34	-	-	Black table skirting	25
6ft rounds	6	-	-	-	-
5ft rounds	16	-	-	-	-
Marble cocktail table	8	-	-	-	-

Staging		Crowd Control/Misc.		Field Suites	
Stage decking (4x8)	108	Metal detectors	119	Black cocktail chair	985
H-frame	56	8ft barricade	387	Cocktail table	133
H-frame 1-cap	17	8ft barricade cover	43	8ft wood table	15
H-Frame 2 cap	64	6ft barricade	41	8ft wood table w/ ex legs	42
H-Frame 4 cap	77	6ft barricade cover	40	6ft wood table w/ ex legs	59
H-frame skirting (8ft)	21	Tensa-barrier	64	-	-
-	-	-	-	Pipe & Drape	-
Z-frame decking	12	Industrial fans	4	P/D upright pole	35
Z-frame	25	Floor fans	4	P/D cross pole	32
Z-frame 1-cap	20	Tower fans	12	P/D bases	37
Z-frame 2-cap	55	Podium	4	P/D linen	56
Z-frame 4-cap	14	Cable tray	59	-	-
Z-frame skirting	20	ADA cable tray	6	-	-
-	-	White boards	6	-	-
Coffin riser staging	4	Power Breezers	10	-	-
-	-	Port-a-cool fans	10	-	-

CONCESSIONS

Concourse Level:

(20) Concession Stands with over 120 Points of Sales

- (4) Recently Renovated Stands with Grab n Go Markets
- State of Art POS System capable of Contactless Payments, Electronic Receipts and Extensive Post Event Reports.

(77) Additional Temporary Locations for Vendor/Concession Activations are available upon request; Additional fees may apply.

- Over 140 Points of Sales available for Tents/Activations from Beverage Portables to Food Vendors.
- State of Art POS System capable of Contactless Payments, Electronic Receipts and Extensive Post Event Reports.

(2) Kitchen Pods with Grill and Fryers; Additional Fees Apply.

Food Truck Partnerships Available Upon Request; Additional Fees Apply

Heritage Concourse Level:

(9) Concession Stands with Chef-Inspired Concepts with over 60 Points of Sale

- Recently Opened in 2019 with Scholarship Tower
- Fully equipped with new equipment and aesthetics. From high volume wood smokers, Mongolian-style grills, pizza ovens and wood-fire grills, our capabilities are limitless on the Heritage Concourse

Lou Galen Club Level

Club Level with Various Stands/Bars with over 26 Points of Sale;

- (3) Concessions Stands with Chef-Inspired Concepts
- (1) “Grab ‘n Go” Market with Wine Cellar
- (2) Luxurious Full-Service Bars with Draft Beer and Wine on Tap
- (2) Outdoor decks with Full-Service Bar, Draft Beer and Food overlooking the Field
- Recently Opened in 2019 with Scholarship Tower fully updated with new equipment and aesthetics

Upper Concourse Level:

(14) Concession Stands with over 120 Points of Sales

- State of Art POS System capable of Contactless Payments, Electronic Receipts and Extensive Post Event Reports

1923 Club Level:

Rooftop View with (1) Concession Stand and (1) Full-Service Bar

- Recently Opened in 2019 with Scholarship Tower fully updated with new equipment and aesthetics

CATERING

Let us transform any location into the perfect setting for your next event. Whether you are looking to host a small gathering for colleagues or an unforgettable reception for 300 guests, our stadium kitchens are equipped and ready to handle cooking in large volumes, bringing to life an exclusive menu with chef-inspired dishes in our world-class event spaces.

Our state of art kitchen is equipped with:

- 3 Industrial Walk-In Coolers
- 1 Industrial Walk-In Freezer
- 3 Steamer/Combination Ovens
- 2 Flattop Griddles
- 3 Deep Fat Fryers
- 1 Char Broiler
- 2 Salamander-Broiling units
- 8 Burner Stovetop Range with convention oven
- 2 Commercial Convection Ovens
- 2 Tilt Skillets
- 1 80 Gallon Steam-Jacketed Kettle
- 1 Sous Vide Immersion Cooking Unit

Available experiences include but are not limited to:

Street Level

- (20) Concession Stands
- Portable Hand-Crafted Cocktail Bars
- Food Truck Partnerships
- Over a dozen Portable Grills, Stoves, Flattops, and Carving Stations for outdoor services

Heritage Concourse

- Chef-Inspired Buffet Stations
- Chef Attended Action Stations and Carving Stations
- Passed Hors d'oeuvres and/or Cocktails
- Portable Hand-Crafted Cocktail Bars
- Delightful Dessert Stations
- (9) Concession Stands

Founders Level 1 or 2

- Chef-Inspired Buffet Stations
- Chef Attended Action Stations and Carving Stations
- Plated Dinner Services
- Passed Hors d'oeuvres and/or Cocktails
- (2) Mixologist-Inspired Full-Service Bars with Draft Beer
- Delightful Dessert Stations
- Café- Inspired Coffee Bar
- Soft Serve Ice Cream Station
- Gelato and Smoothie Bar
- Points of Sales Available for Transactions

Lou Galen Club

- Chef-Inspired Buffet Stations
- Chef Attended Action Stations and Carving Stations
- Plated Dinner Services
- Passed Hors d'oeuvres and/or Cocktails
- (2) Luxurious Full-Service Bars with Draft Beer and Wine on Tap
- (3) Concession Stand Concepts
- (1) Wine Cellar Market
- Points of Sales Available for Transactions

1923 Club

- Chef-Inspired Buffet Stations
- Chef Attended Action Stations and Carving Stations
- Plated Dinner Services
- Passed Hors d'oeuvres and/or Cocktails
- Portable Hand-Crafted Cocktail Bars
- Delightful Dessert Stations
- (2) Concession/Cocktail Stands with Draft Beer
- Points of Sales Available for Transactions



CATERING TERMS AND CONDITIONS

Food and Beverage Deadlines

Submission Policy: Please submit all orders no later than ten (10) business days prior to event

- Signed Banquet Event Order to include estimated guest count and final food and beverage selections
- Set-up selections to include linen, rented china and additional equipment needs
- 20% non-refundable deposit

No later than three (3) business days prior to event, please submit:

- Guaranteed Guest Count
- Detailed Event Timeline
- Signed Banquet Event Order (if guest count changed)

All food and beverage charges will be based on the Guaranteed Guest Count received three (3) business days prior to event.

Any changes made with less than 72 hours notice may be subject to additional charges.



Food and Beverage Minimum

\$5,000 in Food and Beverage Services (not including labor, sales tax, services charges)

Additional Charges for Food and Beverage

Labor Charge of \$200 will be applied for each catering attendant and/or bartender required.

Outside Food and Beverages

It is not permissible for Guests to bring in food and/or beverages from outside the venue. Any food or beverage product brought into the venue without proper authorization will be assessed to the event host at a fee of our normal retail pricing. Alcohol is strictly prohibited and not allowed under any circumstances.

Food and Beverage Service Equipment

In the event additional furniture, silverware, glassware, china or equipment is needed, rentals will be provided and rental fees will be applied. Please contact Legends for pricing.

Food and Beverage Event Tastings

Please inquire with Legends regarding any tastings. Tastings are feasible and will be subject to retail pricing plus labor charges.

Food and Beverage Customization

Interested in a Customized Menu? Inquire with our Catering Team. Additional Charges May Apply

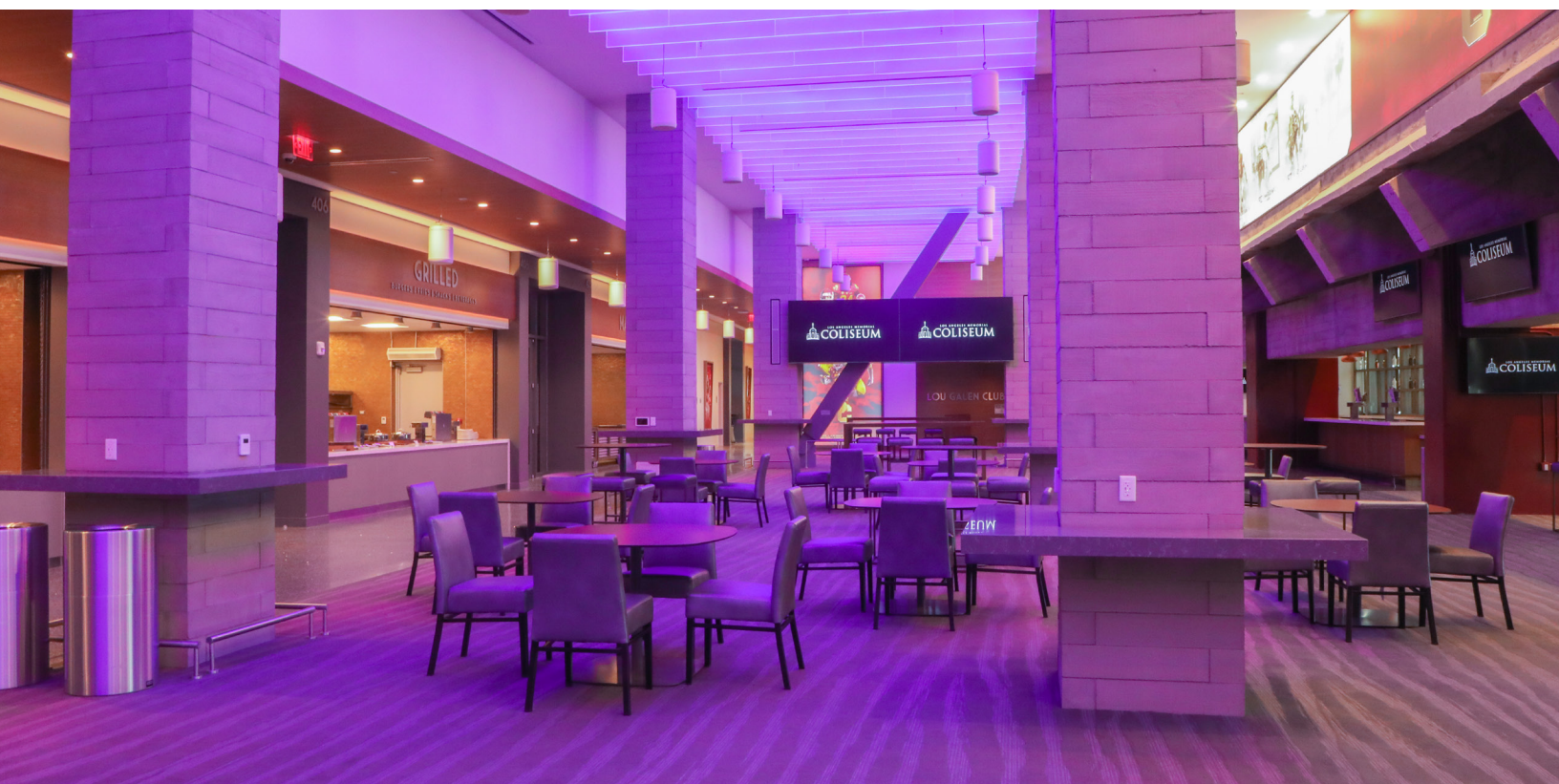

CRAFT SERVICES

Keep your crew satisfied with our in-house craft services. Our spaces and resources allow us to provide high-quality service for crews of any size with ease and flexibility. Whether it's classic snacks and beverages or enhanced offerings, we can service crews in any space. A list of our enhanced services includes but is not limited to:

- Café-Style Coffee Bars
 - Espresso or Barista-Style Drinks Available in Select Locations
- Health and Wellness Stations
 - Includes Whole Fruit, Organic Snacks, and Nutritional Treats
- Stadium-Style Concession Stands, such as Hot Dogs, Pizza, Chicken Tenders, Burgers
- Hydration Stations

RESPONSIBLE ALCOHOL SERVICE

All team members must have completed Responsible Alcohol Service training and maintain an active certification in order to be scheduled for work.

Ensuring alcohol is served and consumed responsibly at United Airlines Field at the Los Angeles Memorial Coliseum is every team member's responsibility, even if you do not directly pour or serve it.

Every team member holds accountability for understanding, observing and ensuring our Responsible Alcohol Service standards are maintained at all times.

Coliseum Responsible Alcohol Policy

- 2 alcoholic beverage limit (maximum), per person per identification
- Drinks cannot be purchased for other guests without additional guest(s) present and able to provide a valid form of identification
- Must be 21 years of age and older to purchase alcohol
- We card anyone that appears under 35 years of age

Please note: Possession of a valid ID is a legal requirement. If a guest cannot provide a **valid ID** if one is requested, they CANNOT be served. An ID that is expired is considered **invalid**.

- ID any guest who appears to be 35 years of age or younger
- Acceptable forms of VALID identification are:
 - State Issued Driver's License
 - State Issued Identification Card
 - Passport
 - Mexican Consular Card
 - Military ID

The following are examples of one drink:

- (1) Packaged / Can Beer (Any ounce size)
- (1) 5oz Glass of Wine
- (1) Single Cocktail containing 1¼oz of 80 proof liquor
 - Souvenir Cocktail is **TWO DRINKS**

Alcohol Cut-Off Times

*Please note the following times apply to all areas that can be accessed by general ticket holders

- Alcohol cut-off for Football is at the start of the 4th quarter
- Alcohol cut-off for Soccer and Rugby is the 70th minute
- Alcohol cut-off for concerts and special events will be no later than 30 minutes before the end of the event.

Responsible Alcohol Service Booth

- Located at section Peristyles
- Manned by a Customer Service team member who takes the pledge of guests to remain sober for the event and serve as a responsible driver
- Guest contact information is obtained by those who take the pledge
- Monthly drawings for prizes are conducted from among the guests who pledged during the previous month

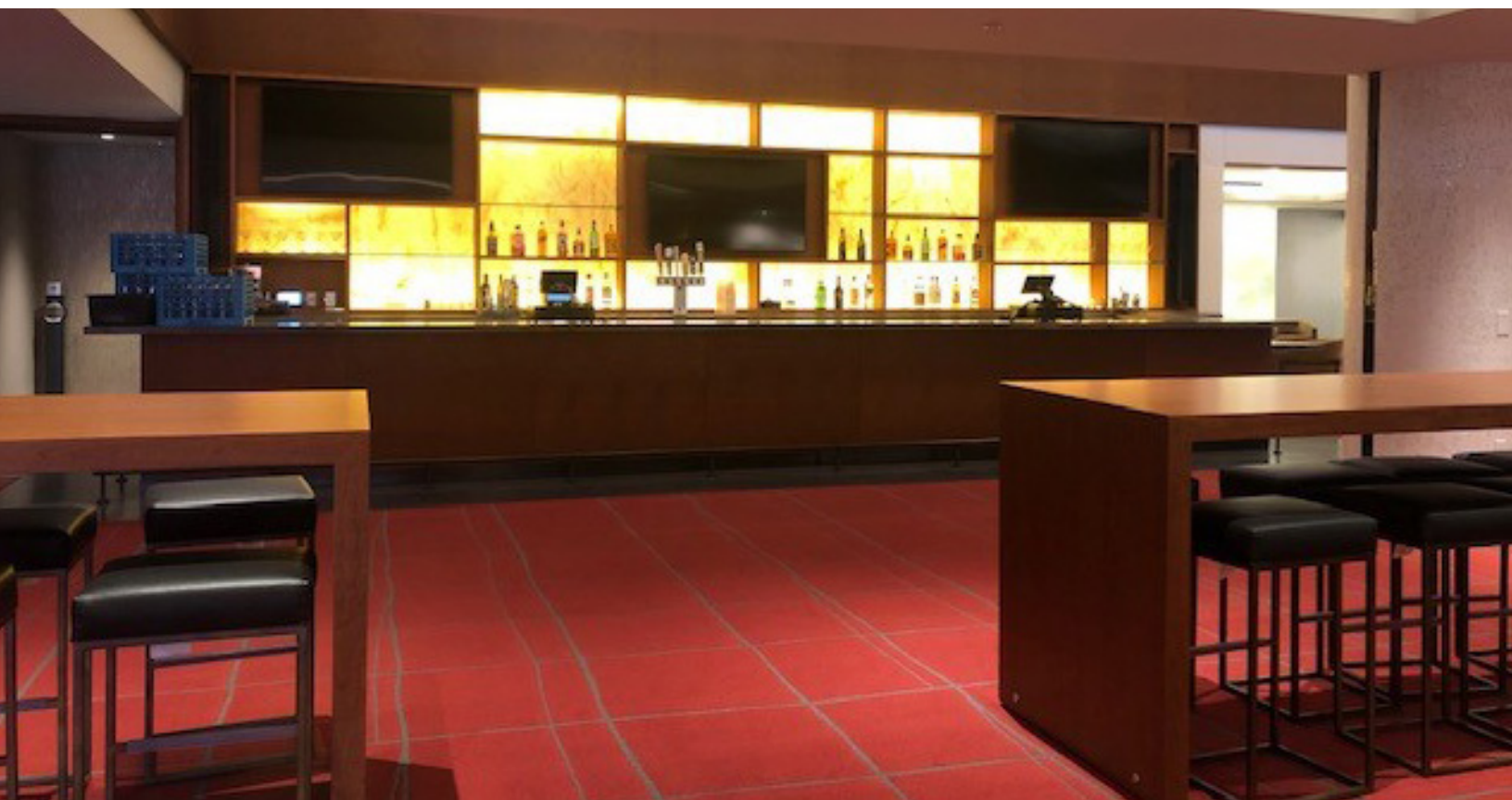

ELEVATORS

The Coliseum has 8 public elevators, 2 service elevators, and 2 freight elevators. Dedicated service elevators for the Scholarship Club Tower are located at Tunnel 9, and service all floors of the Tower. ADA access to the upper concourse is provided by elevators 3, 9 or 10. Freight elevators are located at Section 15 (west end) of the Coliseum for access from the concourse level to the upper concourse level (max weight 4500 lbs.).

There is no elevator access to the locker room or field level.

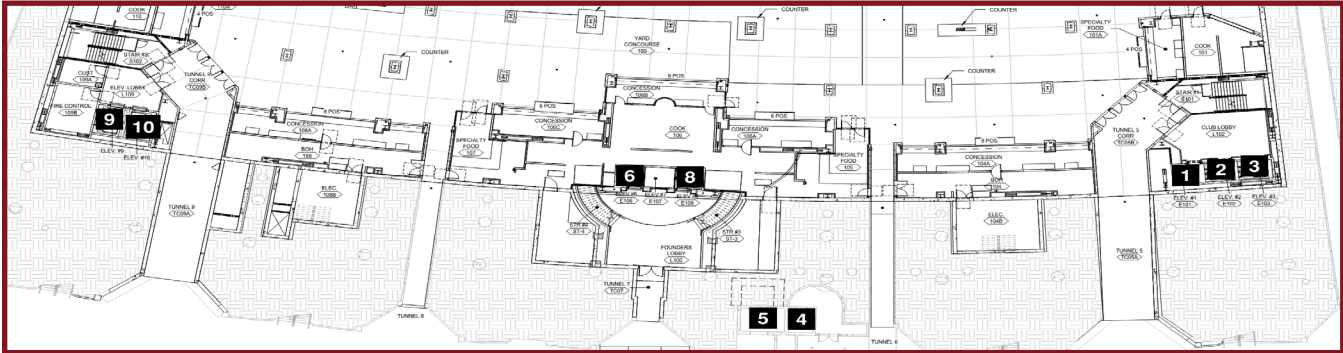

SCHOLARSHIP CLUB TOWER ELEVATOR ACCESS		B1	1	2	3	UC	4	5	6	7
Elevator 1	Tunnel 5 Elevator Lobby		*							*
Elevator 2	Tunnel 5 Elevator Lobby		*				*	*		
Elevator 3*	Tunnel 5 Elevator Lobby	*	ADA			ADA	*	*		
Elevator 4	Press Box Lobby		*					*	*	
Elevator 5	Press Box Lobby		*					*	*	
Elevator 6	Bashor Founders Club		*	*	*					
Elevator 7	(Does Not Exist)									
Elevator 8	Bashor Founders Club		*	*	*					
Elevator 9*	Tunnel 9 Service Elevator	*	ADA	*	*	ADA	*	*	*	*
Elevator 10*	Tunnel 9 Service Elevator	*	ADA	*	*	ADA	*	*	*	*
Elevator 14	Freight Elevator		*			*				
Elevator 15	Freight Elevator		*			*				

* Accesses Floor | ADA: Accessible to Upper Concourse

ENTRANCE GATES

There are six main entrance plazas, located at Gates 1, 4, 8, 19, 23 and 28. Additional service and access gates are located in other areas. Gate 7 is our Founders Club Entrance, with access to service the Scholarship Club Tower. Gate 14 is configured for Media entrance. Gate 31 can be used as an entrance for special events on the Peristyle or Olympic Plaza. Gate 16 and 33 are used for vehicle access.

The Coliseum has a total of 119 CEIA PMD2 Plus Elliptic Enhanced Walk-Through Multi-Zone Metal Detectors that can be deployed for state-of-the-art screening technology for weapon detection.

Entrance	Total Gates	Turnstiles	WTMD
Gate 1	12	16	16
Gate 4	12	13	13
Gate 7	2	HH	3
Gate 8	5	7	7
Gate 14	2	HH	2
Gate 19	14	20	18
Gate 23	12	18	18
Gate 28	16	18	18
TOTAL:	75	95	95

ESCALATORS

Three reversible escalators are located at Tunnels 4, 11 and 19. Each escalator is 48 inches wide, and has a capacity of 10,000 patrons per hour.



FIELD LIGHTING

The Coliseum field lighting was overhauled in 2016 using Musco Lighting’s 328 SportsCluster Green™ LED luminaires. The complete solution is engineered – incorporating advanced structural, electrical, and lighting components – to provide a cost-effective, trouble-free lighting system. The system uses 459 kW energy use at full power and reduces energy consumption by 19% compared to the prior lighting, while increasing vertical light levels by 65%.

There are 8 LED field light towers.

- Approximately 30 seconds from on to full brightness
- Lights turn on and off without a cool down period
- Lights can be programmed in a variety of lighting patterns

Lighting Levels (in foot-candles):

- Average: 150
- Max: 163
- Min: 140

Sports Lighting Measurements

NFL Football

Meter Orientation: End Camera - Ev East

Date: 8/2/2016



143	143	141	141	144	140	140	141	139	135	133	129
140	149	148	145	152	146	146	148	144	141	137	132
141	150	152	152	151	150	149	149	148	148	142	143
146	163	156	155	150	151	154	151	148	151	151	139
157	162	160	159	153	152	155	155	146	146	148	145
140	151	149	149	151	152	159	155	151	145	148	136

Average	150	Max	163	Min	140
Spec	150	U1	0.86	U2	0.94
Max/Min	1.16	(Min/Max)		(Min/Avg)	
Spec	1.5				

MEDIA/VIP ENTRY

Gate 14 is designated for media access or can be used as a VIP entry. A separate enclosed ticket booth with two windows is located here. Gate 14 is located across from the Orange Structure for parking.

NETWORK

Wi-Fi

The Coliseum features 1,400 Wi-Fi access points backed by redundant 40-gigabyte optical internet connections and has the available bandwidth for every mobile device and area within the venue.

Infrastructure bare bones:

- 86 switches
- 1400 AP's
- 150 VOIP phones
- 227 miles of fiber
- 2600 Ethernet ports
- 650 IPTFS

Distributed Antenna System (DAS)

USC and the Coliseum have partnered with Crown Castle to pave the way for next-generation networks, such as 5G, using small cell technology. Los Angeles demands fast, reliable wireless connectivity keeping people connected and helping ensure that your business flourishes. Our DAS network is here to deliver.

IPTV System

Our complete video upgrade includes the installation of an IPTV driven broadcast system consisting of DirecTV channels, house-fed game day content, and customized “L-Bar” sponsorship opportunities which wrap the live game feed with sponsor content. This system is showcased on multiple displays placed throughout the stadium, including the Scholarship Club Tower, concourse, concession stands, and back-office areas.

Conference Room Technology

Room/Area	Capabilities
Founders Suites (Level 2 & 3)	HDMI, Bluetooth & 1/8" Aux Audio Jack input, Crestron AV Remote
Presidents Suite (Level 2)	HDMI, Bluetooth & 1/8" Aux Audio Jack input, Crestron AV Remote, XLR plug in with 2 wireless mics built in
Conference Room #234 (Level 2)	HDMI, Crestron AV Remote with Conference phone built in. speakers surround sound
Lou Galen Club (Level 4)	(2) HDMI Plug ins, (2) XLR plug ins, (2) Wireless mics built in, speakers surround sound, Crestron AV Remote
Conference Room #500 (Level 5)	HDMI, Crestron AV Remote with Conference phone built in. speakers surround sound, Conference Room Camera USB plug in Suites (Level 5) Bluetooth and 1/8" Aux Audio Jack plug in. Crestron AV remote.
1923 Club (Level 7)	(2) HDMI Plug ins, (2) XLR plug ins, (2) Wireless mics built in, speakers surround sound, Crestron AV Remote Music, Game audio feeds, or type of audio can be sent to any floor or all floors as requested

Fiber

NEP Broadcast services manages multiple connections from the press box to the broadcast compound, press box and playing field. Service can be coordinated through John Mills, jmills@nepgroup.com, 972-870-2318, 978-204-7896.

Frequency Coordination

USC utilizes a Frequency Coordinator for all major events at the Los Angeles Memorial Coliseum. Jeff Carter is the designated Frequency Coordinator. Jeff will be conducting a site survey of the Coliseum as well as actively monitoring equipment, frequencies and transmissions during the event. The result will be a confidential database of frequencies in use that can be used to pre-determine potential conflicts and interference. He will also be working on game day to monitor and tag equipment being brought into the Coliseum, track any unregistered frequencies and identify non-compliance.

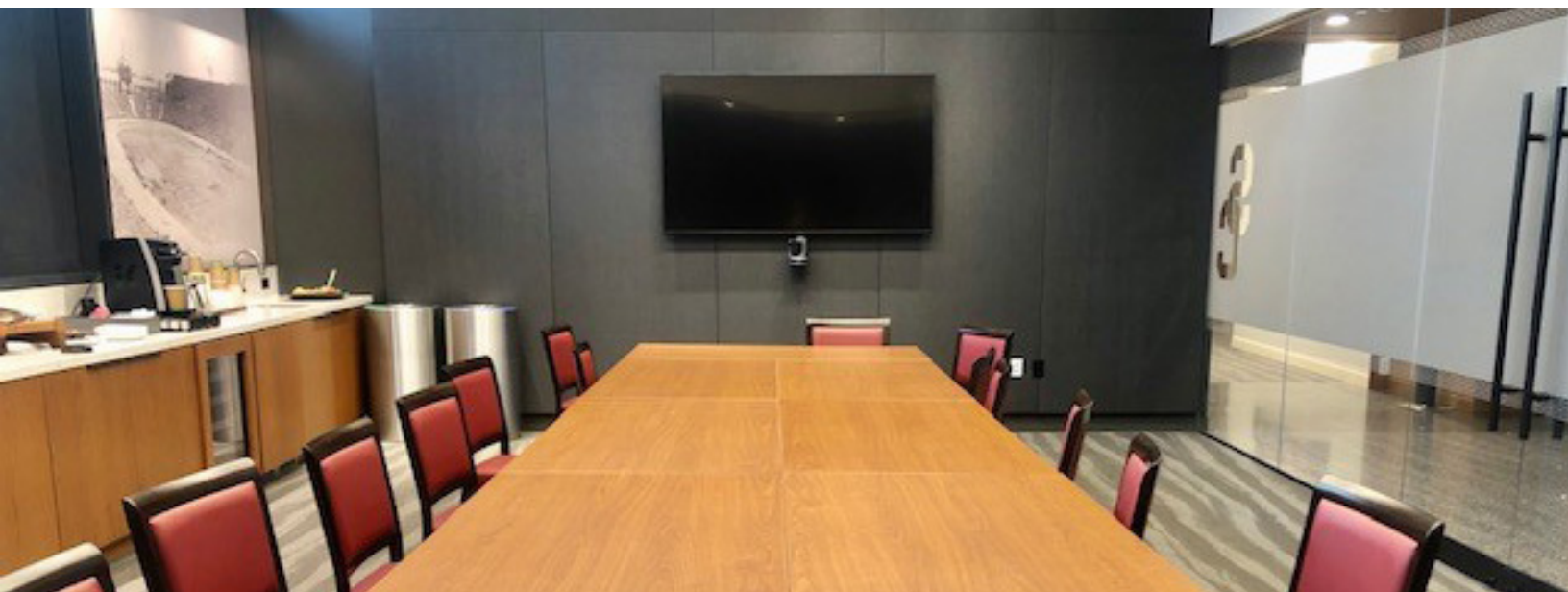

Please coordinate your radio and transmission frequencies with Jeff at his contact info below at least five days before the event.

Jeff Carter

freq@usc.edu

404-374-6618

This information should be provided to any media partners, vendors and working staff that will be transmitting a wireless frequency inside the Coliseum during the game.

Merchandise

Venue Sells. The Licensee retains the novelty privileges (e.g. merchandise, programs, and souvenirs) and shall pay to Licensor twenty percent (20%) of gross sales or other mutually agreed upon amount. Licensor has the right to approve all novelty items sold at the event. Please see Prohibited Items for a list of items not allowed in the venue. All temporary novelty stands used during an event must meet City of Los Angeles Building and Safety Department standards. Your event manager will help determine locations based on the event footprint. USC Bookstore is the preferred LA Coliseum merchandise vendor, with co-branding opportunities available.

Vendor Areas

The Coliseum concourse level contains 77 marked spaces with electrical power for vendor or activation in addition to other open space. Some of these spaces may be shared with concession needs depending on the size of your event.

PERISTYLE

Cauldron

- Takes Approximately 5-7 minutes to warm up
- On windy days, allow for 10 minutes to warm up
- Available for use by request
- If the cauldron is to be on cue, client must include timing into production timeline



Flag Poles

- 12 Existing flag poles for use
- Standard flag size for poles is 4ft tall x 6ft wide
- Clients must source their own flags

Flood Lights

- Peristyle has 4 large LED flood lights and 4 smaller fence line LED light
- All lights automatically turn on at sunset but can be forced off manually



POWER

For Coliseum events, temporary show power is available at the following locations according to the specifications listed.

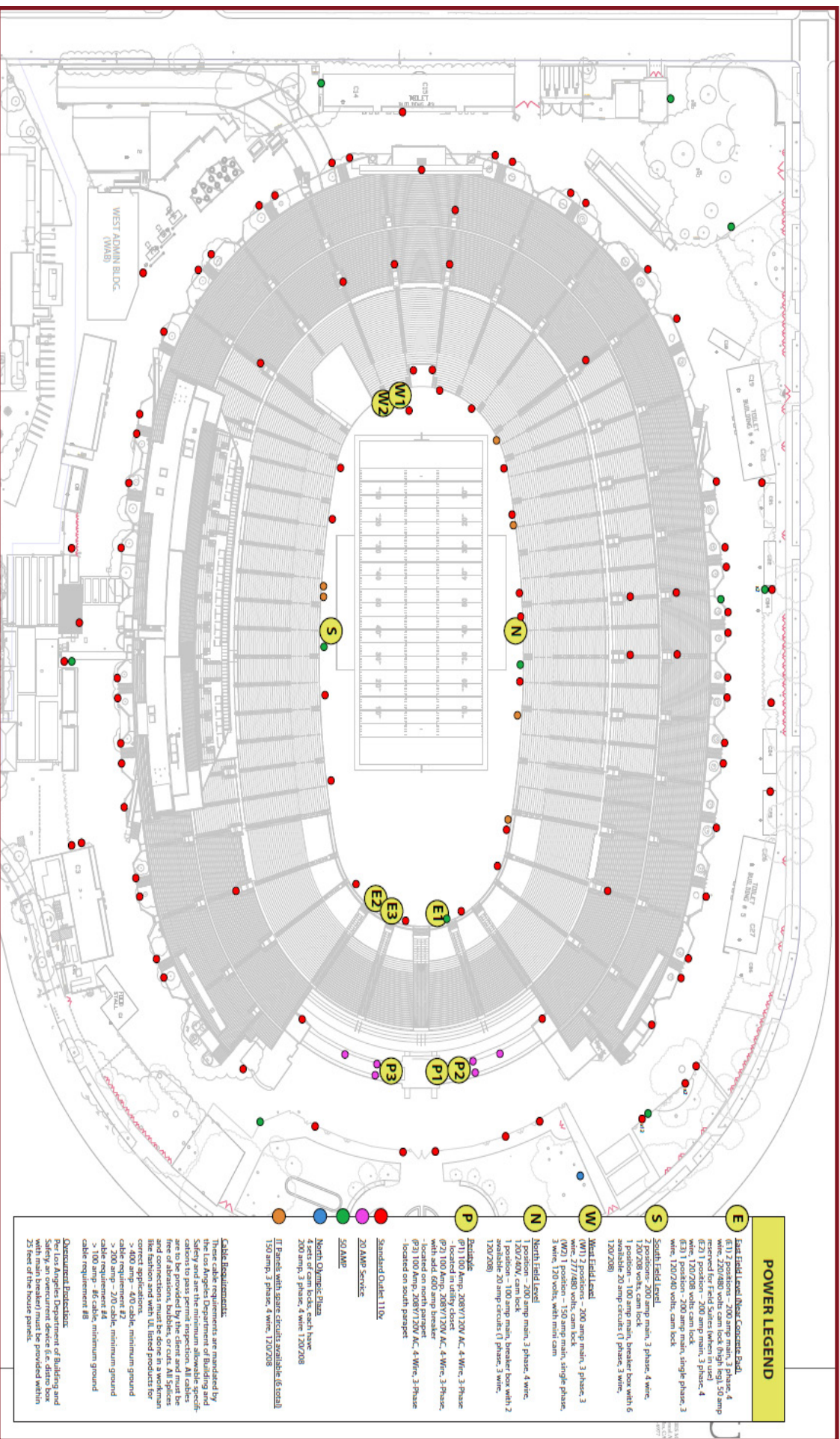

POWER LEGEND

- E** East Field Level Above Concrete Pad.
 - E1) 2 positions - 200 amp main, 3 phase, 4 wire, 200/480 volts cam lock (high leg) 50 amp
 - E2) 2 positions - 200 amp main, 3 phase, 4 wire, 200/480 volts (between 2 feet)
 - E3) 1 position - 200 amp main, single phase, 4 wire, 120/208 volts cam lock
 - E3) 1 position - 200 amp main, single phase, 3 wire, 120/208 volts, cam lock
 - S** South Field Level.
 - 2 positions - 200 amp main, 3 phase, 4 wire, 200/480 volts, cam lock, breaker box with 6 available - 20 amp circuits (1 phase, 3 wire, 120/208)
 - W** West Field Level.
 - W1) 2 positions - 200 amp main, 3 phase, 3 wire, 277/480 volts, cam lock
 - W2) 1 position - 150 amp main, single phase, 3 wire, 120 volts, with mini cam
 - N** North Field Level.
 - 1 position - 200 amp main, 3 phase, 4 wire, 120/208V, cam lock, mini, breaker box with 2 available - 20 amp circuits (1 phase, 3 wire, 120/208)
 - P** Padlock.
 - 9) 110 amp, 208V/120V AC, 4-Wire, 3 Phase - located in utility closet
 - 9) 2) 100 Amp, 208V/120V AC, 4-Wire, 3 Phase, with add 600 amp breaker
 - 9) 3) 100 Amp, 208V/120V AC, 4-Wire, 3 Phase - located on south parapet
 - Standard Outlet 110v**
 - 20 AMP Service**
 - 50 AMP**
 - North Olympic Plaza**
 - 4 sets of cam locks, each have 200 amp, 3 phase, 4 wire 120/208
 - 1) Panels with spare circuits available (6 total 150 amp, 3 phase, 4 wire, 120/208)**
- Cable Requirements:**
 These cable requirements are mandated by the Los Angeles Department of Building and Safety. All cables must be inspected and certified to pass permit inspection. All cables are to be provided by the client and must be free of abrasions, bubbles, or cuts. All splices and connections must be done in a workmanlike manner. All cables must be protected in correct applications.
 > 400 amp - 4/0 cable, minimum ground cable requirement #2
 > 200 amp - 2/0 cable, minimum ground cable requirement #4
 > 100 amp - #6 cable, minimum ground cable requirement #8
- Department of Building and Safety:**
 Per Los Angeles Department of Building and Safety an overcurrent device (i.e. diener box with main breaker) must be provided within 25 feet of the source power.

Coliseum Field					
North Side Panel	Junction Box Type-4 27"x27"x12"				
-	200 amp main	3 phase	3 wire	120/240	Cam-lock 27"x27"x12"
-	100 amp main	1 phase	3 wire	120/208	2 available 20-amp circuits
East Side Panel	Junction Box Type-4 27"x27"x12"				
-	200 amp main	3 phase	4 wire	220/480	Cam-lock 27"x27"x12" (high leg)
-	200 amp main	3 phase	4 wire	220/480	Cam-lock 27"x27"x12" (high leg) 50 amp reserved for Field Suites (if in use).
-	200 amp main	3 phase	4 wire	120/208	Cam-lock 27"x27"x12"
-	200 amp main	1 phase	3 wire	120/240	Cam-lock 27"x27"x12"
South Side Panel	Junction Box Type-4 27"x27"x12"				
-	200 amp main	3 phase	4 wire	120/208	Cam-lock 27"x27"x12"
-	200 amp main	3 phase	4 wire	120/208	Cam-lock 27"x27"x12"
-	100 amp main	1 phase	3 wire	120/208	6 available 20-amp circuits
West Side Panel	-	-	-	-	-
-	200 amp main	3 phase	3 wire	277/480	Cam-lock 27"x27"x12"
-	200 amp main	3 phase	3 wire	277/480	Cam-lock 27"x27"x12"
-	150 amp main	1 phase	3 wire	120/240	Mini Cam-lock

Peristyle/Olympic Plaza					
North Olympic Plaza					
-	200 amp main	3 phase	4 wire	120/208	Cam-lock
-	200 amp main	3 phase	4 wire	120/208	Cam-lock
-	200 amp main	3 phase	4 wire	120/208	Cam-lock
-	200 amp main	3 phase	4 wire	120/208	Cam-lock
Peristyle	-	-	-	-	-
Utility Closet	100 amp main	3 phase	4 wire	120/208	-
	100 amp main	3 phase	4 wire	120/208	With adtl 600-amp breaker
South Parapet	100 amp main	3 phase	4 wire	120/208	-

RESTROOMS

The Coliseum features newly renovated and accessible restrooms. The chart below indicates the number of men's and women's restroom stalls on the concourse and upper concourse levels.

	# of Stalls	# of Urinals	# of Sinks
WBR Upper Concourse 1	11	0	7
MBR Upper Concourse 2	4	19	4
WBR Upper Concourse 3	10	0	7
MBR Upper Concourse 4	4	12	4
WBR Upper Concourse 5	13	0	7
WBR Upper Concourse 7	10	0	7
MBR Upper Concourse 8	4	12	4
WBR Upper Concourse 9	10	0	7
MBR Upper Concourse 10	4	19	4
WBR Upper Concourse 11	12	0	7
MBR Upper Concourse 12	4	19	4
WBR Upper Concourse 13	12	0	7
MBR Upper Concourse 14	4	19	4
WBR Upper Concourse 15	12	0	7
MBR Upper Concourse 16	4	19	4
WBR Upper Concourse 17	12	0	7
MBR Upper Concourse 18	4	19	4
WBR Upper Concourse 19	12	0	7
MBR Upper Concourse 20	4	12	4
WBR Upper Concourse 21	10	0	7
MBR Upper Concourse 22	4	12	4
WBR Upper Concourse 23	13	0	7
MBR Upper Concourse 24	4	12	4
WBR Upper Concourse 25	10	0	7
MBR Upper Concourse 26	4	12	4
WBR Upper Concourse 27	12	0	7
MBR Upper Concourse 28	4	16	4
WBR Concourse Tunnel 2	51	-	21
MBR Concourse Tunnel 3	9	39	14
WBR Concourse Tunnel 9	51	-	21
MBR Concourse Tunnel 10	9	39	14
WBR Concourse Tunnel 14	51	-	21
MBR Concourse Tunnel 15	18	78	28
WBR Concourse Tunnel 15/16	51	-	21

WBR Concourse Tunnel 19	51	-	21
MBR Concourse Tunnel 20	9	39	14
WBR Concourse Tunnel 26	51	-	21
MBR Concourse Tunnel 27	9	39	14
-	571	436	360

Additional restrooms are in the Scholarship Club Tower and field tunnel.

SEATING

There are 76,119 permanent seats in the Coliseum.

Coliseum Seat Widths

Sections 401-412	21"
Sections 103-122, 203-204, 209-210, 218-224, 303, 310	20"
Sections 101-102, 123-127, 200-202, 211-217, 225-228, 300-302, 311-328	19"

TICKETING

Walk-up sales for Coliseum events are handled through ticket booths located at Gates 1 and 19. The booths can accommodate up to 21 window locations for ticket sales, will call and/or customer service. The Main Box Office is located at Gate 29 for ticket operations, advance ticket sales, and customer service.

- Gate 1 (9-window trailer)
- Gate 19 (4-window trailer)
- Gate 29 (main box office, 8 windows)

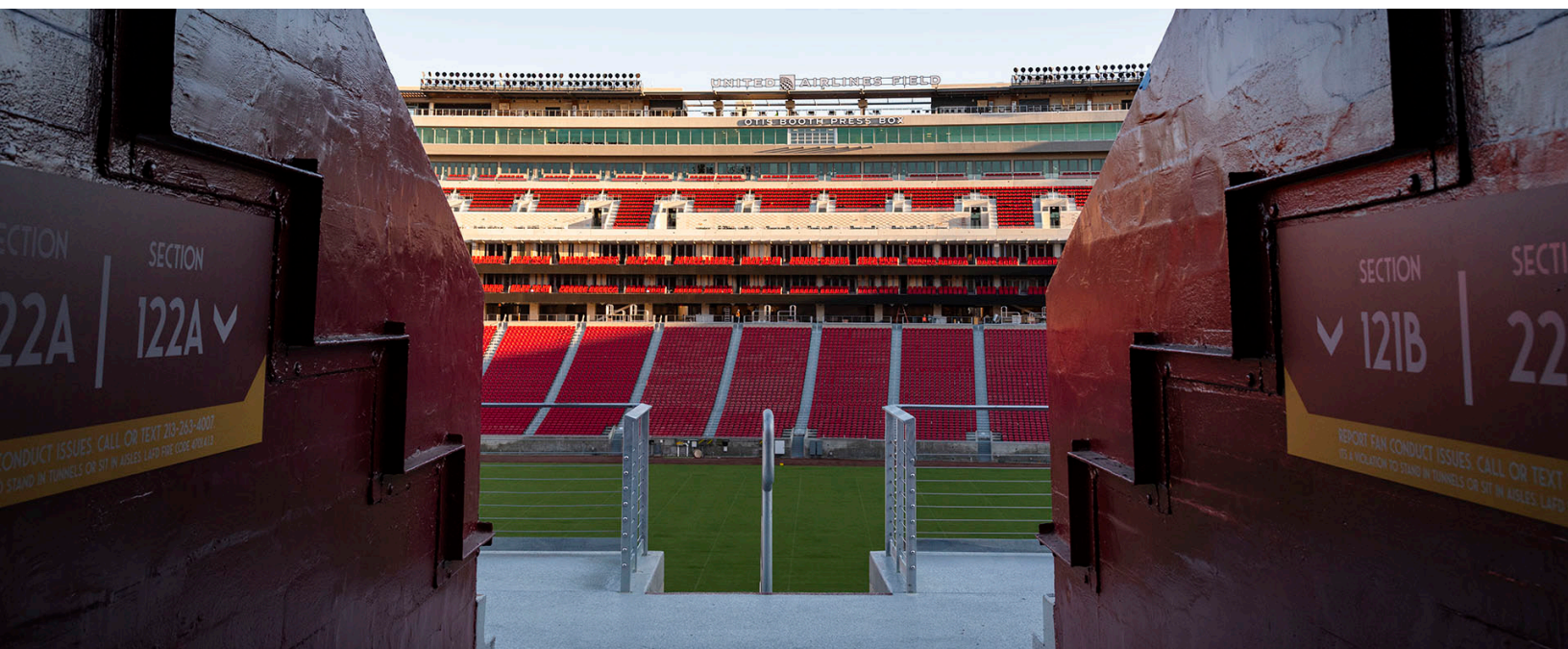

UTILITIES

Utilities are charged based on kWh (kilowatt hours) rate from the Los Angeles Department of Water and Power (LADWP). The Coliseum has a baseline allowance of 3700 kWh. Additional use is charged at a rate of 0.17 per kWh. After 10,000 kWh the rate is 0.52 per kWh.



VIDEO/SCOREBOARDS

Towering above the west end of the Coliseum, our Daktronics video board has a physical dimension of 150' x 40', making it the second largest video display in any college football stadium. It features state of the art clarity (via excellent 15mm resolution), and the ability to broadcast in full HD.

Below is an overview of all the Coliseum displays. For more detail and guidelines on content creation, please consult the Coliseum Content Creation Guide.

A. WEST VIDEO

Display Size: 1920(w) x 508(h)
Physical Size: 150'3"(w) x 39'11"(h)

B. NE and SE VIDEO @ 2

Display Size: 1920(w) x 720(h)
Physical Size: 99'7"(w) x 26'4"(h)

C. PERISTYLE

Display Size: 504(w) x 240(h)
Physical Size: 25'2"(w) x 12'0"(h)

D. FIELD LEVEL @ 4

Display Size: 576(w) x 72(h)
Physical Size: 28'9"(w) x 3'7"(h)

E. ENDZONE BOARDS

Display Size: 1632(w) x 72(h) (x2)
Physical Size: 163'2"(w) x 3'7"(h)

F. TUNNEL

Display Size: 888(w) x 96(h)
Physical Size: 44'5"(w) x 4'9"(h)

G. PRESS BOX RIBBON LEVEL 2

Display Size: 7464(w) x 72(h)
Physical Size: 373.2'(w) x 3'6"(h)

H. PRESS BOX RIBBON LEVEL 3

Display Size: 8136(w) x 72(h)
Physical Size: 406.8'(w) x 3'6"(h)

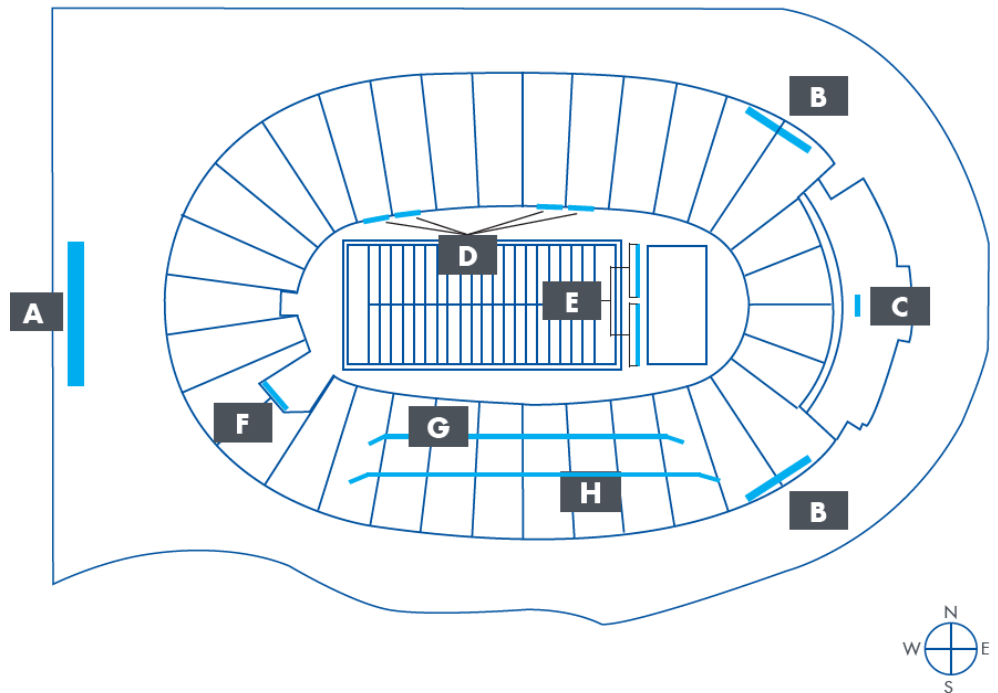

WASTE HAULING

The Coliseum has four (4) 40-yard compactors and sixty (60) 3-yard bins for use. Additional 10-yard and 40-yard roll off services can be provided through Athens Services. Requests must be submitted to the Facility Operations Manager with at least 48 hours of notice.

The Coliseum is committed to Zero Waste. Zero Waste is a set of principles focused on waste prevention that encourages the redesign of resource life cycles so that all products are reused. The goal is for no trash to be sent to landfills, incinerators or the ocean. Additional custodial costs may be incurred for this service. Additional planning/requirements will be necessary to ensure an event is zero waste compliant.

Some of the awards we have won in honor of our Zero-Waste efforts and success include:

- 2019 Pac-12 Zero Waste Challenge – Overall Winner, Co-Champion
- 2019 Green Sport Alliance Environmental Innovator of the Year
- 2018 Outstanding Practices in Venue/Event Resource Recovery Award
- 2017 Pac12 Zero Waste Bowl Champion
- 2016 Pac12 Zero Waste Bowl Champion
- 2015 Pac12 Zero Waste Bowl Most Improved



SITE PLAN

WATER

The Coliseum has a variety of 3/4" and 1" hose bib connectors, in addition to multiple rain bird quick-coupler locations for water sources throughout the field, concourse and upper concourse levels.

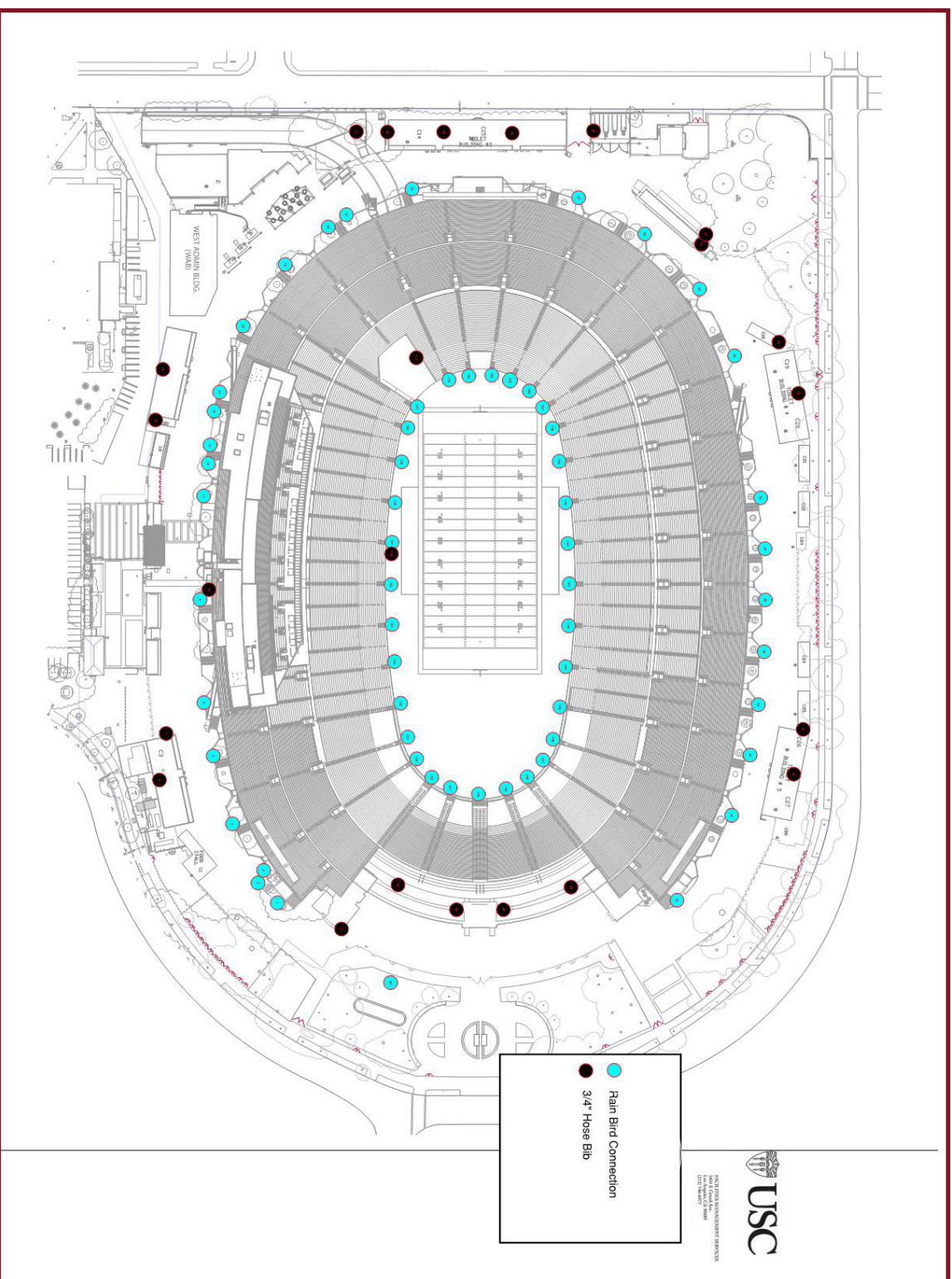

Recent Upgrades

- Every Coliseum gate has a priority line for guests with mobility restrictions until 30 minutes prior to kickoff. Within the final 30 minutes before kickoff, all lanes are open to all guests.
- Outside of the Coliseum, some curb ramps were enhanced to increase accessibility from key parking lot approaches.
- The number of ADA accessible seats has significantly increased.
- Accessible seating sections feature in-seat service for patrons in wheelchairs or with restricted mobility. Information cards are provided at your seating location during the event.
- Handrails and additional aisles have been added to simplify movement about the stadium for guests with mobility restrictions.
- Renovations also feature additional semi-ambulatory seats (aisle seats with arm rests that raise to make it easier to transition in and out of the seat).

Seating

The Los Angeles Memorial Coliseum can accommodate patrons in wheelchairs or with restricted mobility. The Coliseum features multiple areas on the concourse level that do not require ramps or lifts to access.

The Coliseum has 274 ADA general admission seats and 16 ADA seats on club level. The Scholarship Club Tower, Lou Galen Club and 1923 Club have ADA furniture and seating. ADA farm tables are available on Founders (levels 2 and 3) and Suites (level 5) upon request. Coliseum Clubs have ADA seating available. ADA furniture is available for temporary hospitality areas during events.

For guests that need additional assistance reaching seats in the upper levels of the Coliseum, escalators are located adjacent to Tunnels 4, 11, and 19.

Ticketing

ADA Tickets are sold as ADA and companion. ADA Tickets are sold through the same methods of distribution, in the same types and numbers of ticketing sales outlets, and under the same terms and conditions as other tickets sold (e.g., pre-sales, promotions, lotteries, waitlists, and general sales.)

Disabled guests can purchase three additional tickets for seats next to the wheelchair space, provided that the seats are available at the time of purchase. If fewer than three additional adjacent seats are available for purchase, the guest with disabilities must be offered tickets for seats that are as close as possible to the accessible seats. Adjustments can be made by the box office as tickets are sold.

On event day, guests who previously purchased a non-accessible ticket but require accessible seating will be accommodated on a first-come, first-served basis, based on availability.

Parking

ADA Parking is available in Exposition Park. Marked ADA spaces may not be reserved and are subject to availability based on arrival. Event parking permit holders may park in ADA spaces, provided they have a valid ADA placard to do so.

ADA shuttle service is available around Exposition Park to transport ADA guests from the parking lots to gate entrances.

Drop-Off and Pick-Up

Drop-off and pick-up for guests with accessibility needs is located on Exposition Park Drive after entering from South Figueroa at W. 39th Street. Please be aware drop-off and/or pick-up may be difficult due to heavy traffic and congestion. Due to post-game traffic patterns, pick-up in this area may be delayed up to 45-60 minutes after the game until streets can be re-opened for access.

Closed Captioning

Closed captioning services are provided for all major events. The service provides text of all public address announcements during the game. Guests can access the service from the browser on any smart phone or mobile device.

To access the service from your mobile device, please visit www.CaptionedText.com and enter Confirmation: 2650 (for English) at the top of the page.

Closed Captioning is also provided on the Press Box Ribbon video display.

Food and Beverage

In-seat dining available for ADA guests. An information card will be provided at each ADA seat location with available menu items and instructions to text “ADA SERVICE” to 213-263-4007 Ushers and customer service staff will also be trained to request service as needed. Concessions personnel or wait staff are assigned to each ADA seating area for assistance.

Non-fixed condiment counters, tables and pop-up set ups are at proper ADA height of 28” to 34” and have a minimum width of 36” for the full depth. A clear floor space in front is provided of 30” x 48” running parallel to the counter.



Gate Entrances

Every gate has a priority line for guests with mobility impairments up until 30 minutes before kickoff.

Gate 14 Media Check-In Counter is at proper ADA height of 28” to 34” and has a minimum width of 36” for the full depth. A clear floor space in front is provided of 30” x 48” running parallel to the counter.

Gate 29 Security Booth Counter is at proper ADA height of 28” to 34” and has a minimum width of 36” for the full depth. A clear floor space in front is provided of 30” x 48” running parallel to the counter.

Hearing and Visually Impaired

Assistive listening devices for fans with hearing or visual impairments are available for checkout at the Customer Service station, located in the Coliseum West Administration Building across from Tunnel 11.

Service Animals

A service animal is any dog that is individually trained to do work or perform tasks for the benefit of an individual with a disability, including a physical, sensory, psychiatric, intellectual, or other mental disability. Other species of animals, whether wild or domestic, trained or untrained, are not considered service animals.

Service animals are welcome inside the Los Angeles Memorial Coliseum. Service animals must remain on a leash or in a harness at all times unless either the handler is unable because of a disability to use a harness, leash, or other tether, or the use of a harness, leash, or other tether would interfere with the service animal’s safe, effective performance of work or tasks, in which case the service animal must be otherwise under the handler’s control (e.g., voice control, signals, or other effective means).

An aisle seat can be reserved for guests with a service animal, if available.

An animal relief area is provided at Gate 33 in the Olympic Plaza.

Wheelchair Transport

The Los Angeles Memorial Coliseum provides assistance inside all areas of the stadium to guests with special needs. This service is free of charge and can be requested through Customer Service by calling (213) 747-7111 or email lacoliseum@usc.edu. During event hours, call or text (213) 263-4007. The Coliseum does not rent wheelchairs or crutches.

Additional References

LA Memorial Coliseum ADA Information (public): <https://www.lacoliseum.com/ada-information/>

USC Disability Accommodations: <https://policy.usc.edu/disability-accommodations/>

ADA Publication on Ticketing (2010): https://www.ada.gov/ticketing_2010.htm

Information, Guidance and Training on ADA: <https://adata.org/ada-publications>

The Coliseum field is maintained as a competition-ready world class athletic playing surface. Field availability is subject to conditions and at direction of the Sports Turf Director.

Footwear

Cleat usage is only permitted during events involving athletic competition.

For filming productions, all rehearsals need non-cleated footwear. Key actors/actresses can wear cleats with the prior approval from the Sports Turf Director, and if approved, will be limited to wearing cleats only during live filming. Approved shoes are Trainers, Business Flats, and Turf Shoes. Sport cleats, women's flats and heeled shoes require prior approval.

Weather

Field availability is subject to weather conditions. In the case of rain, all field activities will cease, and all equipment will be moved off the field onto field turf or cement areas. In the event of lightning, all field activities must cease for a minimum of 30 minutes until lightning within a 6-mile radius is cleared.

Parking and Tunnel Area

A 20ft Fire lane must ALWAYS be maintained in the tunnel due to the fire regulation. The Coliseum may designate a staff member to jury traffic in the tunnel depending on size and scope of production. Parking is restricted in the tunnel and limited to safety vehicles only. A 10ft clearance is required in front of storage areas.

Vehicles/Motorized Equipment

Motorized vehicles and equipment intended for the field must be submitted to the grounds department with pictures and full specifications (including weight, dimensions, tired, etc.) no later than 24 hours prior to event day. The Coliseum offers motorized carts (with Coliseum operator) and hand carts with field approved tires and proper turf protection to use during load in/load out.

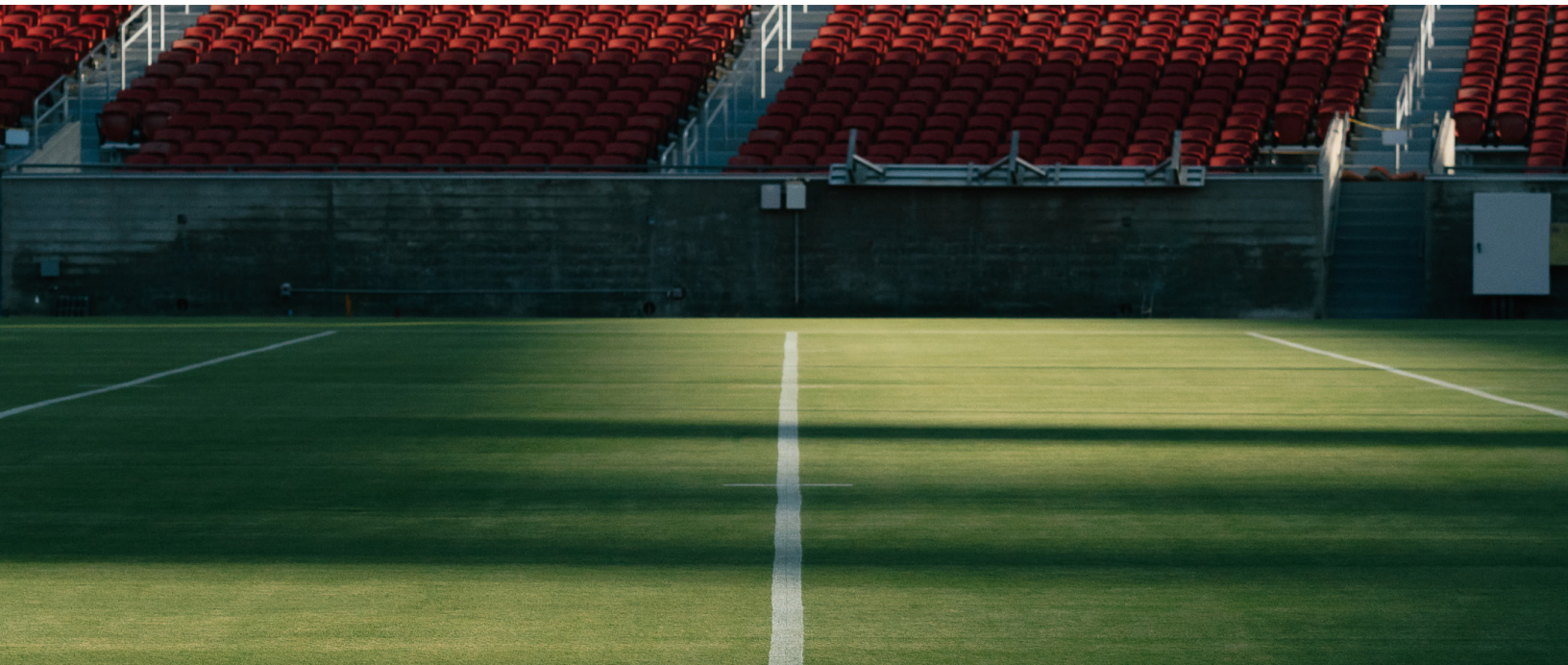

Field Protection

Any equipment or material landing on the field must have a protective surface underneath it. The Coliseum will provide or source turf protection for equipment and material

Pedestrian Flooring is required if:

- The event involves prolonged period of stagnant pedestrian action (EX: concerts, speaking engagements, corporate parties, etc.)
- Events involving heavy pedestrian movement may require pedestrian flooring if over 2000 people.

Drivable Flooring is required if:

- Anything over 1500 lbs
- The Coliseum has 16,000 sqft of drivable protective flooring. All drivable flooring must be a minimum 12 ft wide
Speed of traffic should not exceed 10 mph

During football season, flooring can only be laid down on the field outside the playing surface.



EVENT PARKING

There are 13,615 parking spaces within 3800 feet of the Coliseum within Exposition Park and the USC Campus. Spaces can be reserved in advance and re-sold as pre-paid parking options to support your event

Lot	Total Available Spaces	Designated ADA Spaces (incl. in Total)
Exposition Park		
Pink Lot (Lot 4)	211	10
Yellow Lot (Lot 5)	201	0
Green Lot (Lot 6)	953	20
Blue Structure (Visitor Parking Structure)	1157	32
Orange Structure (South Parking Structure)	1345	24
Total	3867	86
Expo Center		
S. Park Dr. (Boardwalk 1)	37	4
MLK (Boardwalk 2)	54	0
Expo Center East (Boardwalk 3)	45	0
Expo Center North (Boardwalk 4)	26	0
Total	162	4
Banc of California Stadium		
Gold Lot	220	7
Total	220	7
USC Campus		
Downey Way (PSA)	1,493	31
Jefferson Blvd. (PSB)	832	20
Royal Street (PSD)	1,185	25
McCarthy Way (PSX)	761	19
Flower Street (PS1)	1,123	21
Figueroa Street (PS2)	1019	28
Grand Avenue (UPX)	1,300	38
USC Shrine Structure	1,216	24
University Village Garage	437	10
Total	9,366	216
Grand Total of Available Parking	13,615	313

TRUCK STAGING/BUS PARKING

Exposition Park has surface lots with truck and bus parking available. Other off-site lots can be secured to accommodate production trucks and crew.

DIGITAL PARKING

USC and the Coliseum partner with Park Mobile to provide a digital parking solution. Park Mobile lets your guests easily find and pay for parking using their free application or online and delivers a touchless experience.

DIRECTIONS

The Coliseum is located at 3911 S. Figueroa St. Los Angeles, CA 90037 just off I-110 and I-10 in Exposition Park. We are one block south of the University of Southern California, and near several attractions and dining options.

For a map and directions, please visit <https://www.lacoliseum.com/directions/>

During events, the Coliseum partners with Google Maps and the Waze Global Event Partners Program to provide road closures and specific parking lot location to improve the travel experience for guests.

The traffic pattern for major events at the Coliseum relies on a right-turn only policy. Left-turn lane pockets around Exposition Park will be closed.

METRO

The Coliseum is easily accessible via the Metro E Line (Expo) at the Expo Park/USC or Expo/Vermont Stations. <https://www.metro.net/riding/guide/E-line/>

The Metro E Line can be easily accessed with connections at 7th Street/Metro Center in downtown Los Angeles to the B(Red) and D(Purple) Lines, and at Pico Station to the A(Blue) Line. Fans using the L(Gold) Line can make an easy transfer at Union Station for a connection to the E Line. Enhanced service will also be provided during game days.

Guests are reminded to purchase a \$3.50 round-trip fare at the beginning of trips to avoid lines when the games are over. Each person, including children over the age of 5, must have a valid TAP card and remember to tap before each boarding.

Last trains leave from Expo Park at 1:30am for transfers (2:10am for Expo Line only – no transfers). Enhanced service every 6 minutes begins two to three hours prior to kickoff and continues one to two hours after the game.

When leaving the Coliseum, exit the North side of the Coliseum at Gates 19 or 23.

Additional Metro Gameday information is located here: <http://www.metro.net/riding/gameday/>



Metro also has several convenient parking lots available along the E Line:

Station	Facilities	Rates
17th St/SMC 1610 Colorado Av Santa Monica 90401	•65 spaces - paid parking	\$3.00 daily* (zone 501)
Expo/Bundy 12201 Exposition Bl LA 90064	217 spaces - paid parking	\$3.00 daily* (zone 502)
Expo/Sepulveda 11216 Exposition Bl LA 90064	260 spaces - paid parking	\$3.00 daily* (zone 503)
La Cienega/Jefferson 5664 W Jefferson Bl LA 90016	494 spaces - paid parking	\$3.00 daily* (zone 504) *Parking rates do not apply on weekends and holidays
Expo/Crenshaw 3428 Exposition Bl LA 90018	450 spaces - paid parking	\$3.00 daily (zone 505)

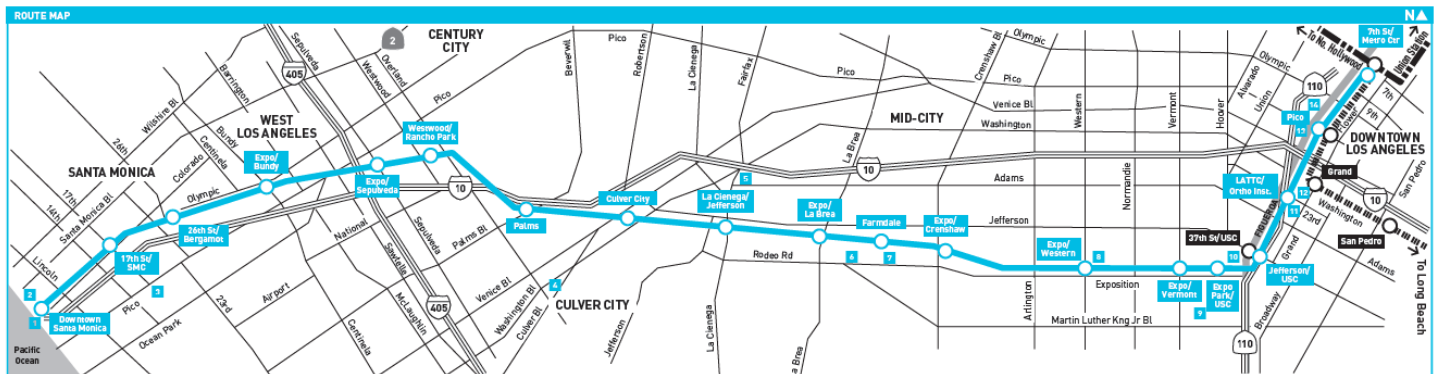

BUILDING SAFETY REQUIREMENTS



BASIC SAFETY

- All aisles and tunnels must remain clear and be maintained as stipulated in the floor plans approved by LADBS/LAFD.
- Smoking is prohibited in the building
- All props and pageantry elements must have up-to-date Certificates of Flame Retardancy. Copies of Certificates must be made available to Coliseum management prior to load-in.

LOS ANGELES DEPARTMENT OF BUILDING SAFETY (LADBS)

Temporary Special Events (TSE) being held within the City of Los Angeles are required to be inspected and approved by LADBS inspectors prior to holding the event. The following qualify as a TSE provided they have a maximum duration of 5 consecutive days:

- Tents or canopies, larger than 450 square feet, on a residential property.
- Tents or canopies, larger than 12 feet in length or width, on a commercial property.
- Stages or platforms more than 30 inches above grade (structures higher than 30 inches intended for live loads require approved engineering prior to inspection).
- Grandstands or bleachers.
- Structures higher than 12 feet.

Visit their website at: <http://www.ladbs.org>.

CABLE INSTALLATION

All cables need to be labeled (at both ends) with the network name and designated location's nomenclature. For example: ESPN HI LT EZ -1; FOX Low Rt EZ - 2. Any stranded or unidentified cable may be removed. All temporary cable installation must be properly secured and not be allowed to droop through pedestrian or viewing areas. Cable-troughs and "J-hooks" are provided in most areas. Cables must be secured and covered in pedestrian areas or seating areas.



ELECTRICAL/WIRING

Vendors and exhibitors must adhere to LADBS requirements to pass inspection:

- All outside power sources must have the proper permits to be used.
- All extension cords used during an event must carry a ground.
- All splices and connections must be done in a workman like manner and with UL listed productions for the correct application. No items can be wired together with wire nuts and tape, unless they are placed in proper electrical boxes.
- All cables must be properly insulated, with all single wire positioned in conduit, free of abrasions, bubbles or cuts.
- No bare single wiring can be exposed at any time.
- All lighting must employ the correct corresponding wire size.
- These cables are the minimum required to pass inspection:
 - 400 amp: 4/0 cable, minimum ground cable requirement #2
 - 200 amp: 2/0 cable, minimum ground cable requirement #4
 - 100 amp: #6 cable, minimum ground cable requirement #8
- An overcurrent device (i.e. distro box with main breaker) must be provided within 25 feet of house panels.

FAN CONDUCT POLICY

In order to ensure a safe and enjoyable environment, we ask that fans refrain from the following behavior at all events.

- Profanity or other offensive language or gestures, whether spoken, written or appearing on apparel
- Smoking (including vaporizers, e-cigarettes and smokeless tobacco)
- Intoxication or excessive alcohol consumption or signs of substance impairment that results in irresponsible behavior
- Bringing or attempting to bring prohibited items into the venue
- Throwing of items or liquids
- Entering the playing field or court at any time
- Fighting or other threatening behavior, including verbal or physical harassment
- Failure to retain ticket and/or present it to event staff if requested to do so
- Resale of tickets at the venue
- Violation of state or local laws
- Failing to follow instruction of stadium personnel or stadium policies

FAILURE TO COMPLY MAY RESULT IN EJECTION OR ARREST

Fans are encouraged to report inappropriate behavior to management personnel. For assistance, call or text 213-263-4007. Message and data rates may apply.

PROHIBITED ITEMS

All persons and their belongings are subject to metal detector screening and bag inspection prior to entering the Coliseum. Guests are encouraged to arrive early to avoid delays. All prohibited items will not be allowed inside the Coliseum.

The following items are NOT ALLOWED in the Coliseum:

- Bags, Backpacks or Purses which do not meet Bag Policy guidelines. Hard or Soft Coolers, Baskets, Packages or Containers;
- Alcoholic Beverages, Bottles or Cans. (Factory sealed bottles of water, 17 oz. or less, are allowed; limit 2 per person);
- Illegal Drugs and Weapons including Firearms, Knives, Explosives, Fireworks, Lighters and Laser Pointers;
- Professional Cameras (lenses longer than 3”) and Camera Equipment, Selfie-Sticks, Tripods and Video or Audio Recording Equipment;
- Banners, Sticks, Poles, Inflatables, Frisbees, Balls, and Unsliced Fruits or Vegetables;
- Umbrellas, Balloons, Strollers, Skateboards and Folding or Beach Chairs;
- Pets (Service Animals are allowed);
- The Coliseum is a smoke-free environment. Smoking and smoking implements are prohibited in any area of the Coliseum.

Please do not conceal items. Have all items clearly visible inside an approved bag. All Bags must meet Bag Policy guidelines and are subject to inspection upon entry. For more information on the Coliseum Bag Policy, please visit <http://www.lacoliseum.com/beclear>.



CLEAR BAG POLICY

The Coliseum prohibits bags, backpacks and other containers from entering the venue, with the following exceptions:

- One bag that is clear plastic, vinyl or PVC and does not exceed 12" x 6" x 12", or a one-gallon clear plastic storage bag (Ziploc bag or similar);
- In addition to one of the clear bags noted above, guests may also carry in a small clutch bag or purse approximately the size of a hand, with or without a handle or strap; and
- An exception may be made for medically necessary items after proper inspection.

Prohibited bags include, but are not limited to: purses larger than a clutch bag, coolers, briefcases, backpacks, fanny packs, cinch bags, luggage of any kind, oversized seat cushions with pockets or metal structures, computer bags, camera bags or any bag larger than the permissible size.

These measures are designed to promote public safety while encouraging guests to limit the items they bring into the venue to create a more efficient screening and entry process. We ask that all items are visible when entering the venue. The fewer items that are concealed, the quicker the process becomes.

All approved bags are subject to inspection upon entry. For more information on the Coliseum Bag Policy, please visit www.lacoliseum.com/beclear.

The clear bag policy affects the type and size of the bags permitted into the stadium — not the items (keys, makeup, combs, phones, wallets, and credit cards) that you would normally bring to a game. Guests can still carry these items in their pockets. Guests will also be allowed to openly carry a blanket or jackets into the stadium, though they will be subject to search.



LOS ANGELES MEMORIAL COLISEUM 

CLEAR BAG POLICY

The infographic illustrates the permitted bag types and their dimensions:

- CLEAR TOTE (VINYL OR PVC):** Dimensions are 12" wide and 12" high.
- SMALL CLUTCH BAG:** Dimensions are 6.5" wide and 4.5" high.
- 1 GALLON ZIPLOC BAG:** Dimensions are 6" wide and 6" high.

WWW.LACOLISEUM/BECLEAR

FLOOR PLANS

An approved floor plan or seating plan for the Coliseum must be submitted before any event can occur or tickets are placed on sale. The plans must be approved by the Los Angeles Fire Department. Any modifications to these plans can only take place with the approval of the Los Angeles Fire Department.

ON-SITE FIRE INSPECTOR

Certain events may require the presence of an on-site Fire Inspector. Responsibility for this cost will be with the licensee.

PERMITS

As the permits required for an event can vary considerably, please consult your Event Manager to discuss permits that may be required for your event. Permits are typically required for:

- Los Angeles Department of Building Safety (LADBS) – temporary structures
- Los Angeles Department of Public Health (LADPH) – outside food activations, sampling
- Los Angeles Fire Department (LAFD) – occupancy for public assembly, vehicle displays, pyrotechnics
- Los Angeles Police Department (LAPD) – traffic planning, risk management



Unmanned Aircraft Systems (UAS) – “Drones”

The Coliseum does not permit the use of drones during an event. At all other times, a permit is required by LAFD and operates under authority of 14 CFR – Part 107 which requires:

- Be compliant with FAA Part 107 https://www.faa.gov/uas/commercial_operators/
- Provide a copy of the Remote Pilot Certificate
- Provide your FAA drone registration or remote ID https://www.faa.gov/uas/getting_started/register_drone/
- Provide a plan of operation including description of flight activities, flight times, location of controller/pilot and take-off and landing areas.
- Provide certificate of insurance of general liability coverage naming University of Southern California as additionally insured.
- Pilots must keep the UAS within line of sight at all times. UAS must be flown at speeds below 50 knots and below 400 feet above ground level. UAS are also required, generally, to maintain a distance of 500 feet from all production personnel.

Pyrotechnics

All use of pyrotechnics, compressed gases and other special effects in conjunction with an event must have the expressed written approval of the Los Angeles Fire Department and Coliseum Management.

- Every display shall be under the control and supervision of a Pyrotechnic Operator licensed by the State Fire Marshal and shall be conducted under conditions as required by LAFD.
- Every applicant for a permit to conduct a fireworks display shall submit evidence of having a Fireworks Public Display License or a Fireworks General Public Display License granted by the State Fire Marshal.
- The fireworks in public displays shall be located, discharged and of such character so as not to be hazardous to persons or property.

The Coliseum works closely with Pyro Spectaculars on many productions, including USC Football and the annual July 4th celebration.



PERMANENT BUILDING SIGNS

All permanent building signage must remain up and not be covered. Additional temporary event signage may be added where space allows. There is no non-compete or exclusive categories currently (subject to change without notice).

TEMPORARY EVENT SIGNS

The Coliseum partners with AAA Flag & Banner to produce stunning graphics transforming simple concrete walls and metal fence lines into opportunities to showcase your brand and enhance your event experience.

Your Event Manager can provide a robust installation deck referencing easily identifiable codes to reference for quick quotes and faster ordering of common signage areas.

Please note AAA Flag & Banner is a preferred vendor with years of experience working with this National Historic Landmark. Your production is not required to contract with AAA, but there may be limitations to installation at the venue with outside contractors. All scope for installation with an outside contractor must be reviewed and approved by Coliseum Management in advance of the event. Temporary event signage must be fully removed within 72 hours after the event or as conditions may require. Your production is responsible for any damages that may be caused from adhesives or other structural mounting. Please let us know if you have any questions before proceeding.

FLAG POLES

The east rim of the Coliseum features 74 flag poles (43 on the northwest end and 31 to the southwest). The exterior of the Peristyle has 12 total poles with an even split of 6 on the north and 6 to the south of the Olympic cauldron.

BANC OF CALIFORNIA STADIUM

During LAFC games (only), exposure of partnership signage is prohibited from Coliseum areas visible from Banc of California stadium. This affects mainly the area from Olympic Plaza to Gate 1. This is only applicable during the same time an LAFC event is taking place.



CALL TIMES

	Hours prior to KICKOFF/EVENT START	Hours prior to GATES OPEN
Reception/Early Call	6:00	4:00
Event Staff Entrance Opens	6:00	4:00
Building Ops Call	4:00	2:00
Parking Lots Open	4:00	2:00
Box Office/Will Call Opens	4:00	2:00
Supervisors Call	3:30*	1:30*
Staff Call	3:00*	1:00*
-	-	-
Doors Open	2:00	0:00

* For major events of 25,000 or more persons these times may adjust +0:30.

EXPOSITION PARK

When coordinating events within Exposition Park, it may be important to note the neighboring museum operating hours.

- Natural History Museum of Los Angeles County: 9:30am – 5:00pm every day. Closed New Year’s Day (January 1), Independence Day (July 4), Thanksgiving Day (fourth Thursday of November), Christmas Day (December 25). <https://nhm.org/>
- California Science Center: 10:00am – 5:00pm every day. Closed New Year’s Day, Thanksgiving and Christmas. <https://californiasciencecenter.org/>
- California African American Museum: Tuesday - Saturday 10:00am-5:00pm; Sunday 11:00am-5:00pm. <https://caamuseum.org/>
- Expo Center (Los Angeles Parks and Recreation): Monday through Friday – 6:00am to 8:00pm Saturday – 9:00am to 5:00pm Sunday - Closed <https://www.laparks.org/reccenter/roy-anderson>
- Lucas Museum of Narrative Art: Opening Spring 2023. <https://lucasmuseum.org/>

NOISE CURFEW

While there is no formally defined curfew within Exposition Park for noise, we generally suggest to not extend your event past 11:00 PM. Exposition Park is boundaried by the campus of USC and residential neighborhoods.

Sound should be no greater than 110 dB at FOH position.

Below is a listing of community services near the Coliseum. Hours and availability may be subject to change. This list is not an endorsement of any establishment and is only provided for reference.

DRY CLEANING/LAUNDRY

- Royal Couture Cleaners | 4051 S Broadway, Los Angeles 90037 | (310) 451-3663 | 7am-5pm
- John's Village Cleaners | 1401 W. Jefferson Blvd Los Angeles 90037 | (323) 733-0987 | 7am-5pm
- Neighborhood Laundromat | 811 W. Vernon Ave. Los Angeles 90037 | (323) 846-3627 | 24 Hrs.

HOTELS

USC Hotel

3540 S Figueroa St. Los Angeles, CA 90037

(213)748-4141

<https://uschotel.usc.edu/>

Omni Los Angeles Hotel at California Plaza

251 S Olive St, Los Angeles, CA 90012

(213) 617-3300

<https://www.omnihotels.com/hotels/los-angeles-california-plaza?>

Hotel Figueroa

939 S Figueroa St, Los Angeles, CA 90015

(213) 627-8971

<https://www.hotelfigueroa.com>

HOSPITALS

California Hospital Medical Center

1401 S. Grand Ave. Los Angeles, CA 90015

(213) 748-2411

Good Samaritan Hospital

1225 Wilshire Blvd. Los Angeles, CA 90017

(213) 977-2121

FIRE STATION

Los Angeles Fire Department Station 46

4370 S Hoover St, Los Angeles, CA 90037

(213) 485-6246

POLICE STATION

Los Angeles Police Department – Southwest Community Police Station

1546 W Martin Luther King Jr Blvd, Los Angeles, CA 90062

(213) 485-2582

PHARMACY

- USC Pharmacy | 3601 Trousdale Pkwy Los Angeles 90089 | (213) 740-2738 | 9am-5pm
- USC Health Center | 1150 W. Jefferson Blvd #150 LA, CA 90089 | (213) 821-6100 | 9am-5:30pm
- CVS Pharmacy | 3335 S. Figueroa St. Los Angeles 90007 | (213) 742-6765 | 8am-8pm

RIDESHARE

Lyft is the official rideshare partner of the Los Angeles Memorial Coliseum. Lyft has rides for any occasion, and with Lyft, your guests can get to or from the Coliseum safely with one of Lyft's many ride options. Download the Lyft app today.

We have identified strategic drop-off and pick-up areas around Exposition Park that are convenient and safe for drivers and passengers and meet our goal of traffic management. During major events, other rideshare services and general pickup is prohibited from entering the Exposition Park area until one hour after the event.

TAXI/LIMO

- Independent Taxi Cab Co | <https://lataxi.com/new/> | (800) 521-8294
- Yellow Cab Company | <https://layellowcab.com/> | (424) 222-2222
- Premiere Sedan & Limousine | <https://premierlimo.co/> | (866) 983-3331

PROMOTER GUIDE

FILMING GUIDE

BROADCAST MEDIA GUIDE

VIDEOBOARD CONTENT CREATION GUIDE

FREEWAY SIGN GRAPHIC GUIDE

TICKETMASTER EVENT ARTWORK GUIDE

COLISEUM TURNSTILE EVENT ARTWORK GUIDE

COLISEUM WEBSITE EVENT ARTWORK GUIDE

AAA FLAG & BANNER VENUE SIGNAGE INSTALLATION GUIDE

These additional guides are accessible at <https://www.lacoliseum.com/promoter-technical-guides/>

Password: **Production!**

FLOOR PLANS

Please see the Coliseum Promoter Guide for references to existing floor plans.

